

Addendum No. 1

Date: November 6, 2023

Project: WESD Yamhill Center Sidewalk Improvements

To: Prospective Bidders

This addendum forms a part of the Contract Documents and modifies the original Construction Documents dated August 2023 as noted below, and becomes a part of the Contract Documents.

This addendum consists of 2 pages, plus attachments.

POINTS OF CLARIFICATION:

1. Question: Has an ODOT permit been issued?
Answer: ODOT Engineer Casey Knecht has reviewed and approved the drawings. The awarded contractor shall contact Steve Barner to get a miscellaneous permit for work in the ODOT right-of-way.
Steve Barner
503-986-2890
Steve.BARNER@odot.oregon.gov
2. Question: Does the sidewalk need to route around the existing light poles?
Answer: Four feet of clearance is required at light poles.
3. Question: Does the excess soil need to be hauled off site?
Answer: Excess soil can be left on site in a location identified by WESD for future projects.

LIST OF ATTENDEES

1. See attached list from pre-bid meeting.

CIVIL DRAWINGS:

1. Sheet C0.0: Replace this sheet in its entirety. Updated sheet index.
2. Sheet C1.1: Replace this sheet in its entirety. Updated per ODOT comments.
3. Sheet C2.0: Replace this sheet in its entirety. Updated per ODOT comments.
4. Sheet C2.1: Add this sheet in its entirety per ODOT comments.
5. Sheet C4.2: Add this sheet in its entirety per ODOT comments.
6. Sheet C4.3: Add this sheet in its entirety per ODOT comments.
7. Sheet C4.4: Add this sheet in its entirety per ODOT comments.

PROJECT MANUAL:

1. Section 00 1113 Invitation for Bid, first paragraph:
 - a. Delete "Marion Center" and replace with "Yamhill Center".
 - b. Delete "2611 Pringle Road SE, Salem, OR 97302-1533" and replace with "2045 SW Highway 18, McMinnville, OR 97128".
2. Section 00 2113, Instructions to Bidders, section 1.13, paragraph A: Delete "January 23, 2024" and replace with "March 1, 2024".

End of Addendum 1.

Attachments:
List of Attendees
Sheet C0.0
Sheet C1.1
Sheet C2.0
Sheet C2.1
Sheet C4.2
Sheet C4.3
Sheet C4.4
Section 00 1113
Section 00 2113

PRE-BID CONFERENCE ATTENDANCE SIGN-IN

Project: WESD Sidewalk Improvements

Pre-bid Conference Time and Date: 2:00 PM on November 2, 2023

NAME	AGENCY / COMPANY	PHONE	E-MAIL
1. Troy Saunders	Premier Property Dev.	503-560-2452	Brenda@premierpropertydev.com
2. Taylor Hawthorn	Haworth INC	971-237-5872	Taylor@Haworthinc.net
3. BRAD CHRISTOPHERSEN	STANDARD COMM CONSL	541-974-7466	brad@standardcommercialconstruction.com
4. Ryan Hartman	Owen Construction	503-949-1836	Drew@owenconstructioninc.com
5. Trevor Wickwire	Wickwire Contracting	541-852-7525	Tanner@wickwire.com
6. DON Nienke	DID concrete & Utilities Inc.	503-266-5229	DON@DIDcon.com
7. Kelly Vader	Lee Contractors LLC	360-723-5295	hardy@leecontractorswa.com
8. Chris Szedlak	Concrete Solutions Incorporated	503-437-2233	Coszedlak@comcast.net
9. Jim Galbraith	BENCHMARK Contracting	503-780-9760	Kelly@BENCHMARK-PRO.COM
10. Alexis Bloomer	Brown Contracting, Inc.	541-654-3388	sean@browncontracting.net
11. Aaron Slowik	Emery & Sons	503-588-7576	bids@emeryandsons.com
12. BULTENA ENGINEERING INC		707-344-0442	MIKE@BULTEN-ENG.COM
13.			
14.			
15.			
16.			
17.			
18.			

DRAWINGS FOR:

WILLAMETTE EDUCATION SERVICE DISTRICT
YAMHILL CENTER SIDEWALK IMPROVEMENTS

FOR:

ANGELA FLORES, AIA
CARLSON VEIT JUNGЕ ARCHITECTS
3095 RIVER RD N
SALEM, OR 97303



- SURVEY NOTES
1.

BASIS OF BEARINGS AND COORDINATE SYSTEM IS BASED ON OREGON STATE PLANE NORTH ZONE 3601, NAD83(2011), EPOCH 2010.00. ALL DISTANCES SHOWN HEREON ARE GROUND DISTANCES.
2.

ELEVATIONS WERE ESTABLISHED BY GPS RTK OBSERVATIONS TO YAMHILL COUNTY GPS CONTROL POINT "BOOTH-44856050". MARK IS A BRASS DISK IN A MONUMENT BOX IN THE CENTERLINE OF SW BOOTH BEND ROAD, APPROXIMATELY 300 FEET EAST OF PACIFIC HIGHWAY 99W. ELEVATION = 147.51' (NGVD29)
3.

THE LOCATION OF UTILITIES SHOWN HEREON ARE FROM OBSERVED VISIBLE EVIDENCE OF ABOVE GROUND APPURTENANCES ALONG WITH SURFACE UTILITY MARKINGS BY OTHERS. ALL UNDERGROUND UTILITIES SHOWN WERE MARKED ON THE SURFACE BY AN "OREGON ONE-CALL NOTIFICATION CENTER" REQUEST. SURVEYOR MAKES NO GUARANTEE AS TO THE ACCURACY OF SAID MARKINGS, HOWEVER, THEY ARE LOCATED AS ACCURATELY AS THEY ARE MARKED ON THE GROUND.
4.

PER ORS 209.150, ANY SURVEY MONUMENT REMOVED, DISTURBED OR DESTROYED SHALL BE REPLACED BY A PROFESSIONAL LAND SURVEYOR WITHIN 90 DAYS AT THE EXPENSE OF THE PERSON OR PUBLIC AGENCY RESPONSIBLE FOR SAID REMOVAL, DISTURBANCE OR DESTRUCTION.
5.

FIELD SURVEYED JUNE, 2023.

PROJECT LOCATION

IN THE SW 1/4 OF SECTION 29,
T.4S., R.4W., W.M. CITY OF
MCMINNVILLE, OREGON

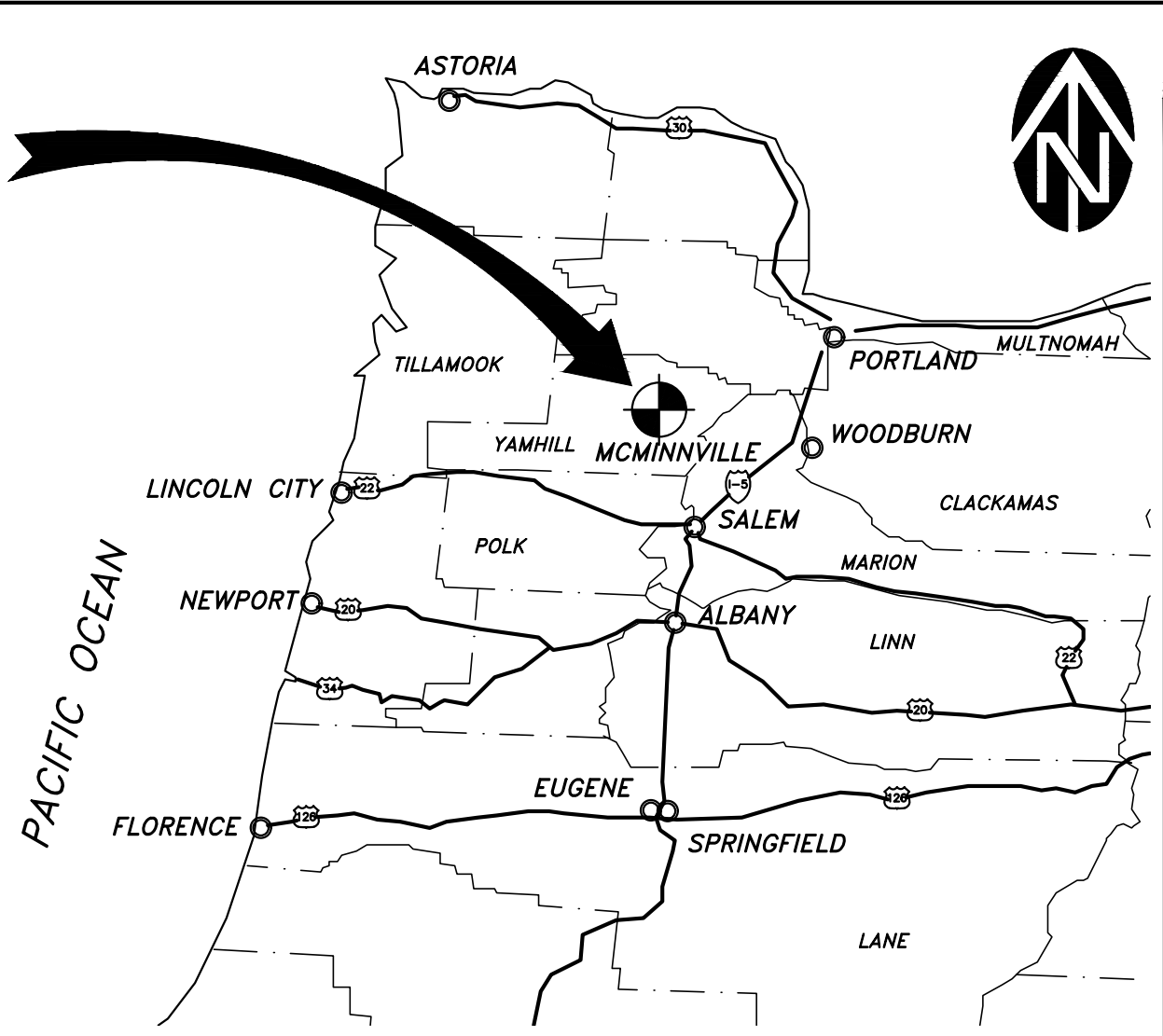

LEGEND

●

FOUND MONUMENT

CATCH BASIN

WATER METER

WATER VALVE

WATER VAULT

FIRE HYDRANT

FIRE DEPT. CONNECTION

IRRIGATION VALVE

ELECTRICAL VAULT

LIGHT POLE

JUNCTION BOX

COMMUNICATION RISER

COMMUNICATION BOX

GAS VALVE

TRAFFIC SIGNAL BOX

TRAFFIC SIGNAL POLE

CONCRETE

DECIDUOUS TREE & TRUNK SIZE

CONIFEROUS TREE & TRUNK SIZE

— SD —

STORM LINE UNDERGROUND

— W —

WATERLINE UNDERGROUND

— G —

GAS LINE UNDERGROUND

— T —

COMMUNICATION LINE UNDERGROUND

— E —

ELECTRICAL LINE UNDERGROUND

— GA —

GAS LINE ASBUILT DATA

CONC.

CONCRETE

HCR

HANDICAP RAMP

INSTR. NO.

DEED INSTRUMENT NUMBER

VICINITY MAP

SHEET INDEX

SHT NO	DESCRIPTION
C0.0	COVER SHEET, VICINITY MAP, LEGEND, & INDEX
C1.0	EXISTING CONDITIONS, DEMOLITION, & EROSION CONTROL PLAN
C1.1	POST DEVELOPED EROSION CONTROL PLAN
C1.2	EROSION CONTROL NOTES & DETAILS
C2.0	SIDEWALK IMPROVEMENT PLAN & TYPICAL SECTION
C2.1	ENLARGED CURB RAMP DETAILS
C3.0	CONSTRUCTION NOTES
C4.0	DETAILS
C4.1	DETAILS
C4.2	DETAILS
C4.3	DETAILS
C4.4	DETAILS
—	—
—	—
—	—
—	—

CARLSON
VEIT
JUNGE
ARCHITECTS PC

ARCHITECTURE • INTERIOR DESIGN
3095 RIVER RD N, SALEM, OREGON 97303
WWW.CARLSONVEIT.COM • 503-390-0281

DIGITALLY SIGNED

REGISTERED PROFESSIONAL ENGINEER
76415PE
OREGON
NOV. 12, 2008
WILLIAM J. WELLS
RENEWS: 6/30/2024

project:
WILLAMETTE EDUCATION SERVICE DISTRICT
YAMHILL CENTER SIDEWALK IMPROVEMENTS
2045 SW HIGHWAY 18
MCMINNILLE, OR 97328

consultants:
WESTTECH ENGINEERING, INC.
CONSULTING ENGINEERS AND PLANNERS
3841 Fairview Industrial Dr. S.E., Suite 100, Salem, OR 97302
Phone: (503) 585-2474 Fax: (503) 585-3986
E-mail: westtech@westtech-eng.com

revisions:

1	8-23-23	ADDED SIDEWALK RAMP & DETAILS
2	9-6-23	PER ODOT COMMENTS

date: AUGUST 2023
project: 3445.1000.0
dwg file: C0.0
drawn by: TN
checked by: JW
copyright © 2023
Carlson Veit Junge Architects PC

COVER SHEET,
VICINITY MAP,
LEGEND & INDEX

sheet:
C0.0
of:

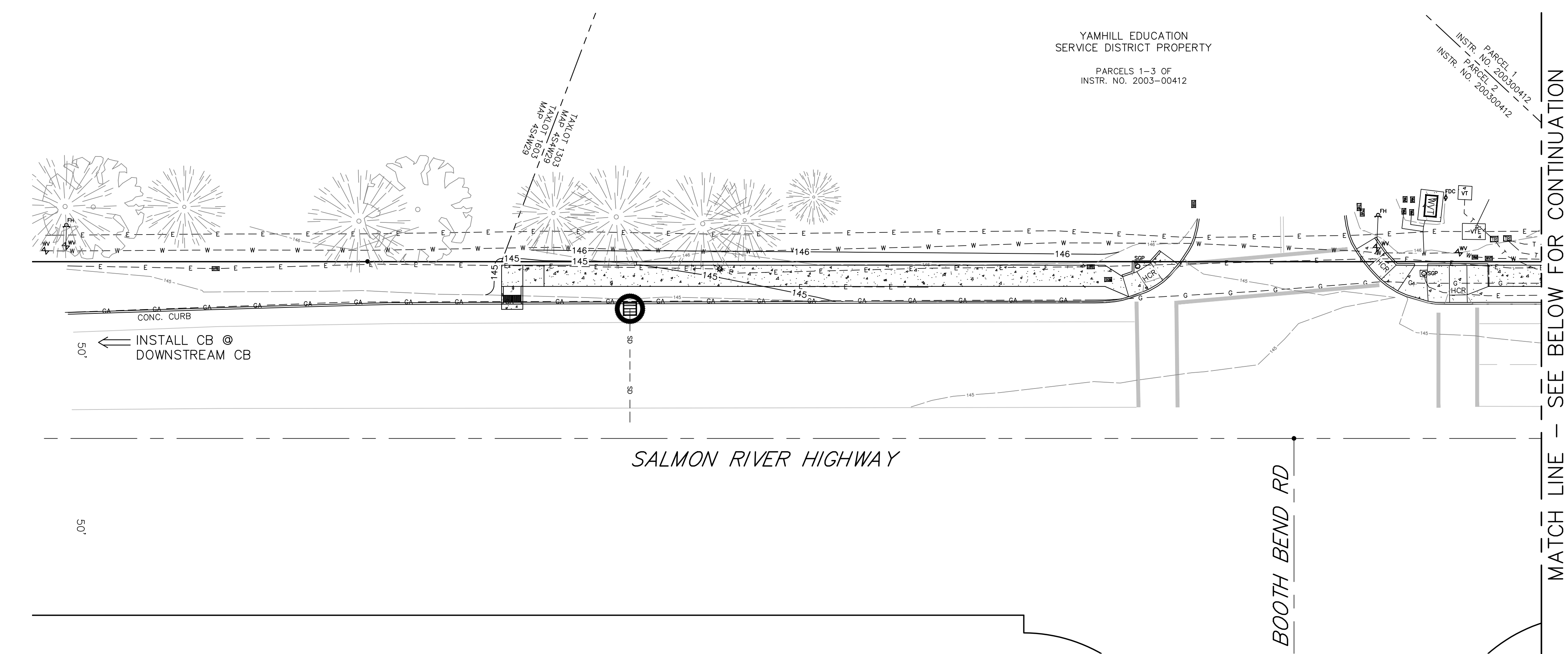

SALMON RIVER HIGHWAY POST DEVELOPED EROSION CONTROL PLAN

1" = 20'

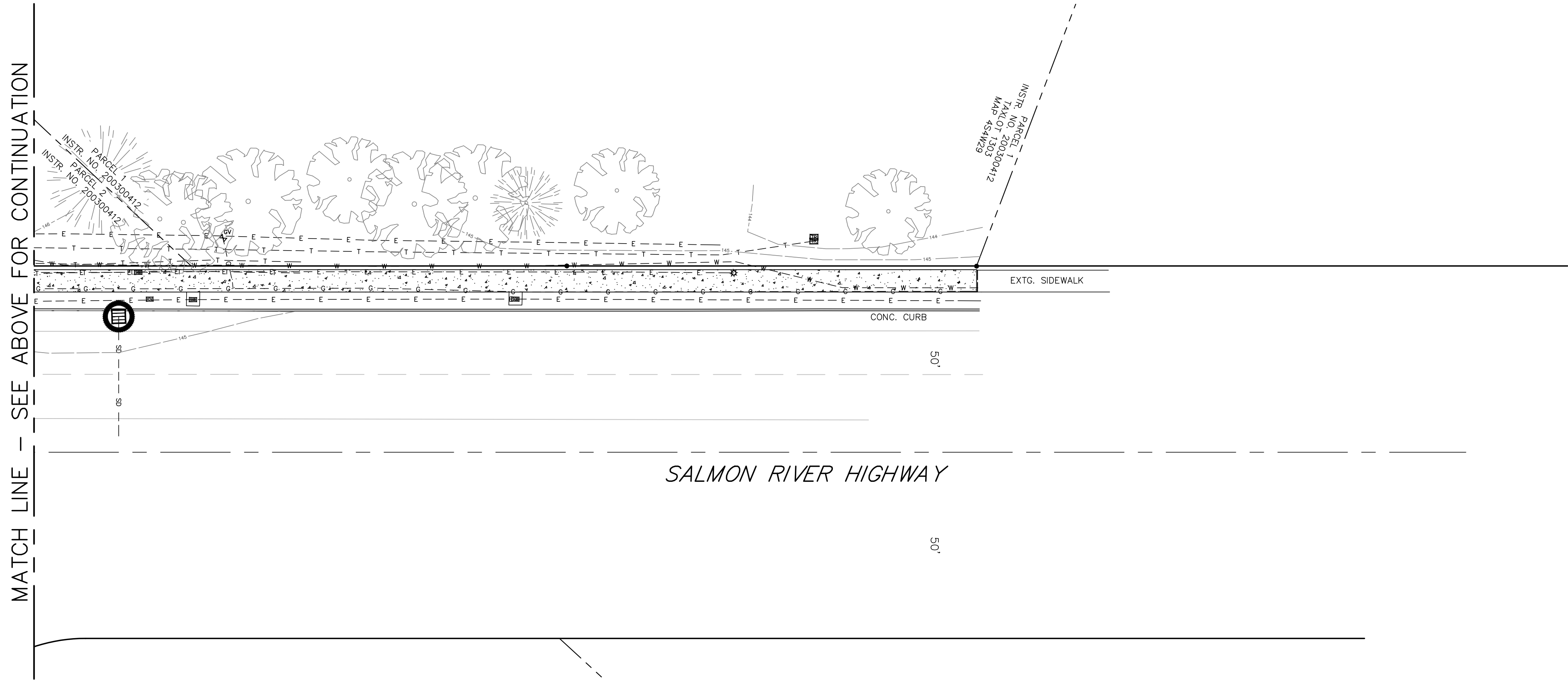

SALMON RIVER HIGHWAY POST DEVELOPED EROSION CONTROL PLAN

1" = 20'

CARLSON
VEIT
JUNGE
ARCHITECTS PC

ARCHITECTURE • INTERIOR DESIGN
3095 RIVER RD N. SALEM, OREGON 97303
WWW.CARLSONVEIT.COM • 503-390-0281

REGISTERED PROFESSIONAL
ENGINEER
76415PE
DIGITALLY SIGNED
OREGON
NOV. 12, 2008
WILLIAM J. WELLS
RENEW: 6/30/2024

project:
WILLAMETTE EDUCATION SERVICE DISTRICT
YAMHILL CENTER SIDEWALK IMPROVEMENTS
2045 SW HIGHWAY 18
MCMINNILLE, OR 97328

consultants:
WESTTECH ENGINEERING, INC.
CONSULTING ENGINEERS AND PLANNERS
3841 Fairview Industrial Dr. S.E., Suite 100, Salem, OR 97302
Phone: (503) 585-2474 Fax: (503) 585-3986
E-mail: westtech@westtech-eng.com

revisions:
2 9-6-23
PER ODOT COMMENTS

date: AUGUST 2023
project: 3445.1000.0
dwg file: C1.1
drawn by: TN
checked by: JW
copyright © 2023
Carlson Veit Junge Architects PC

POST DEVELOPED
EROSION CONTROL
PLAN

sheet:
C1.1
of:

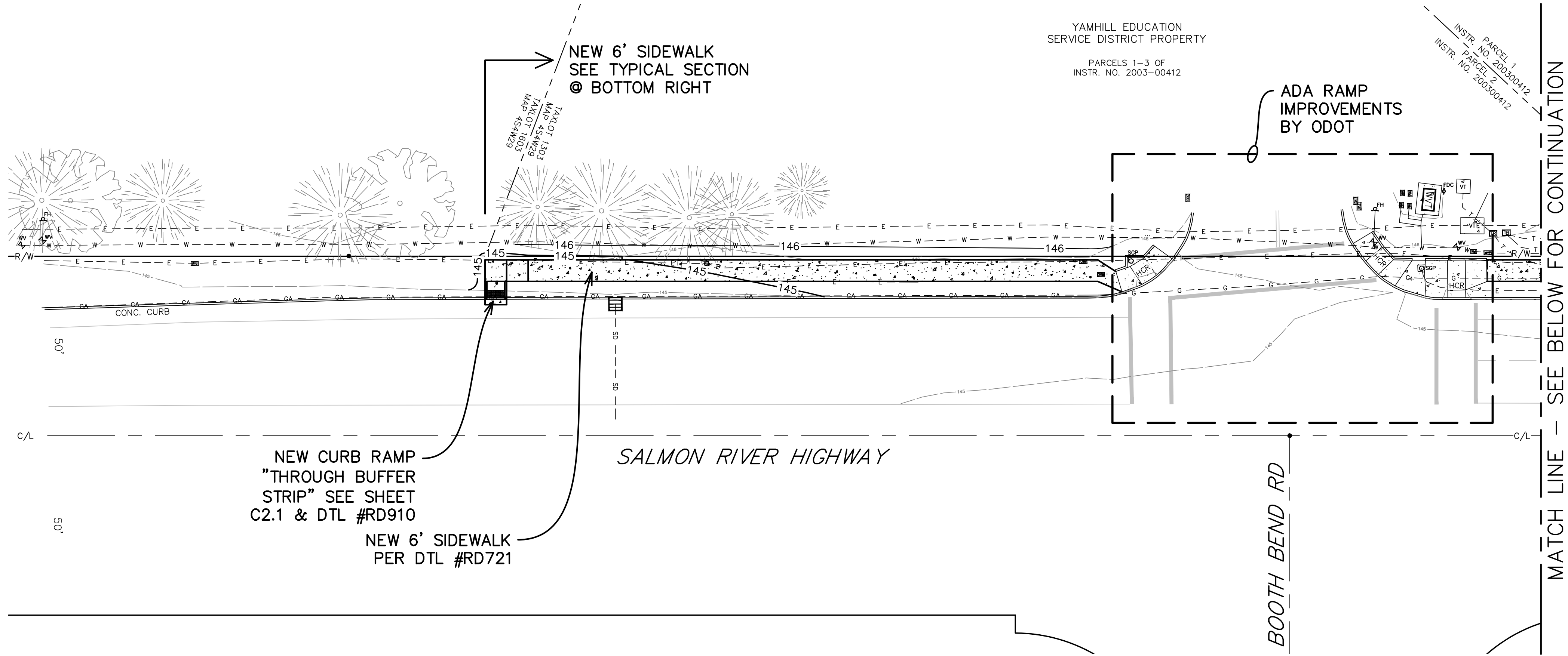

SALMON RIVER HIGHWAY SIDEWALK PLAN
1" = 20'

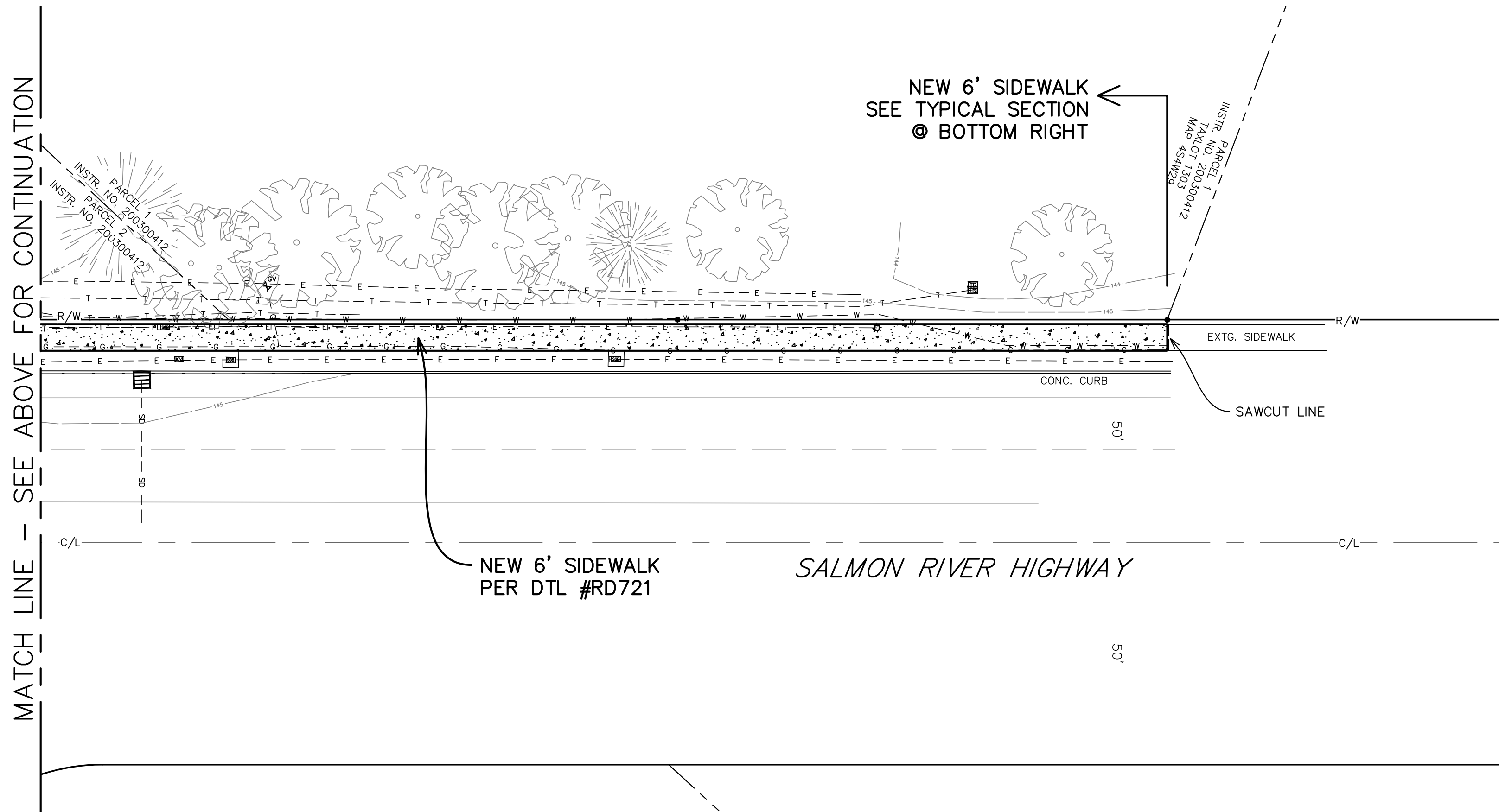

SALMON RIVER HIGHWAY SIDEWALK PLAN
1" = 20'

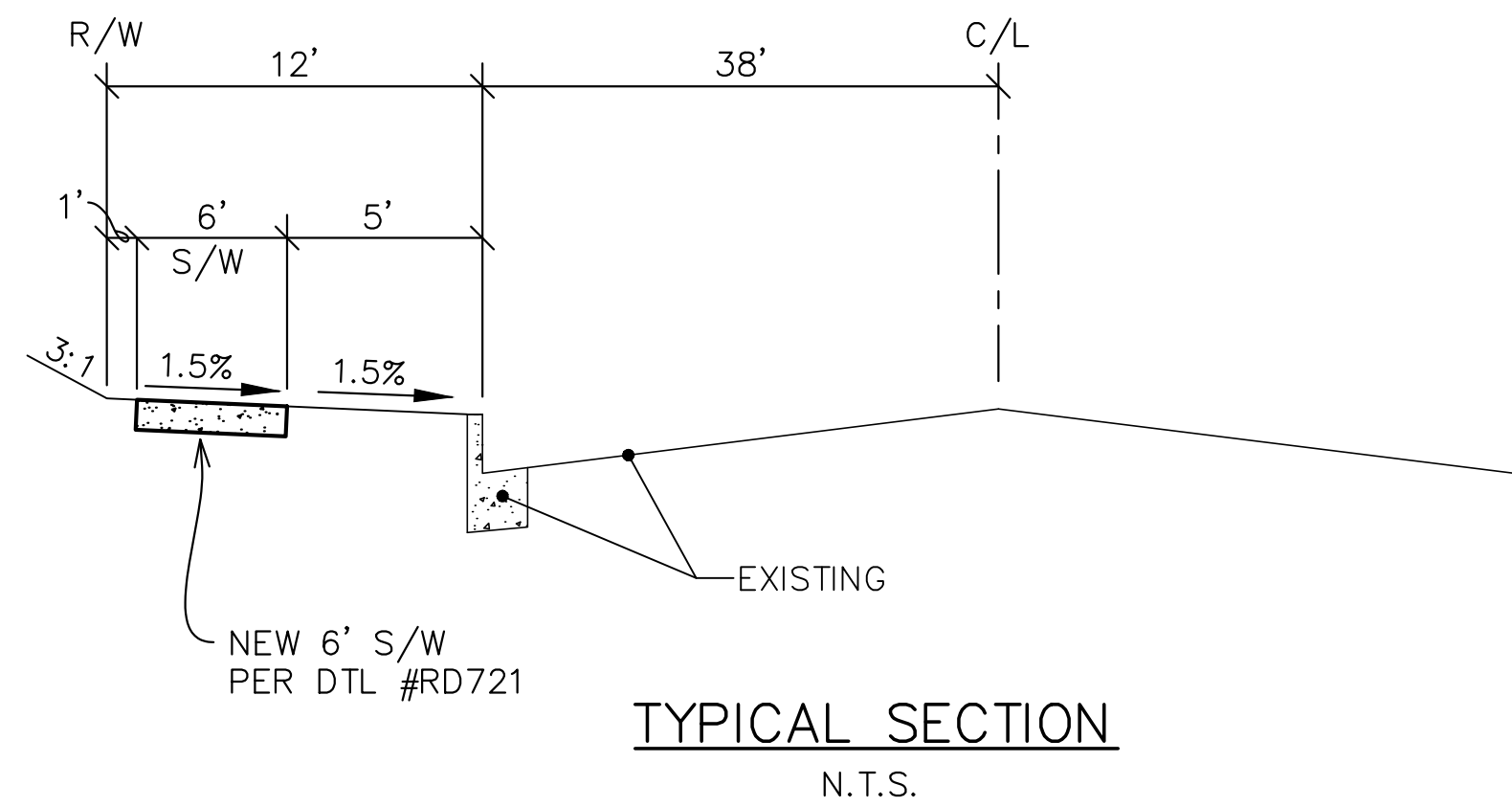

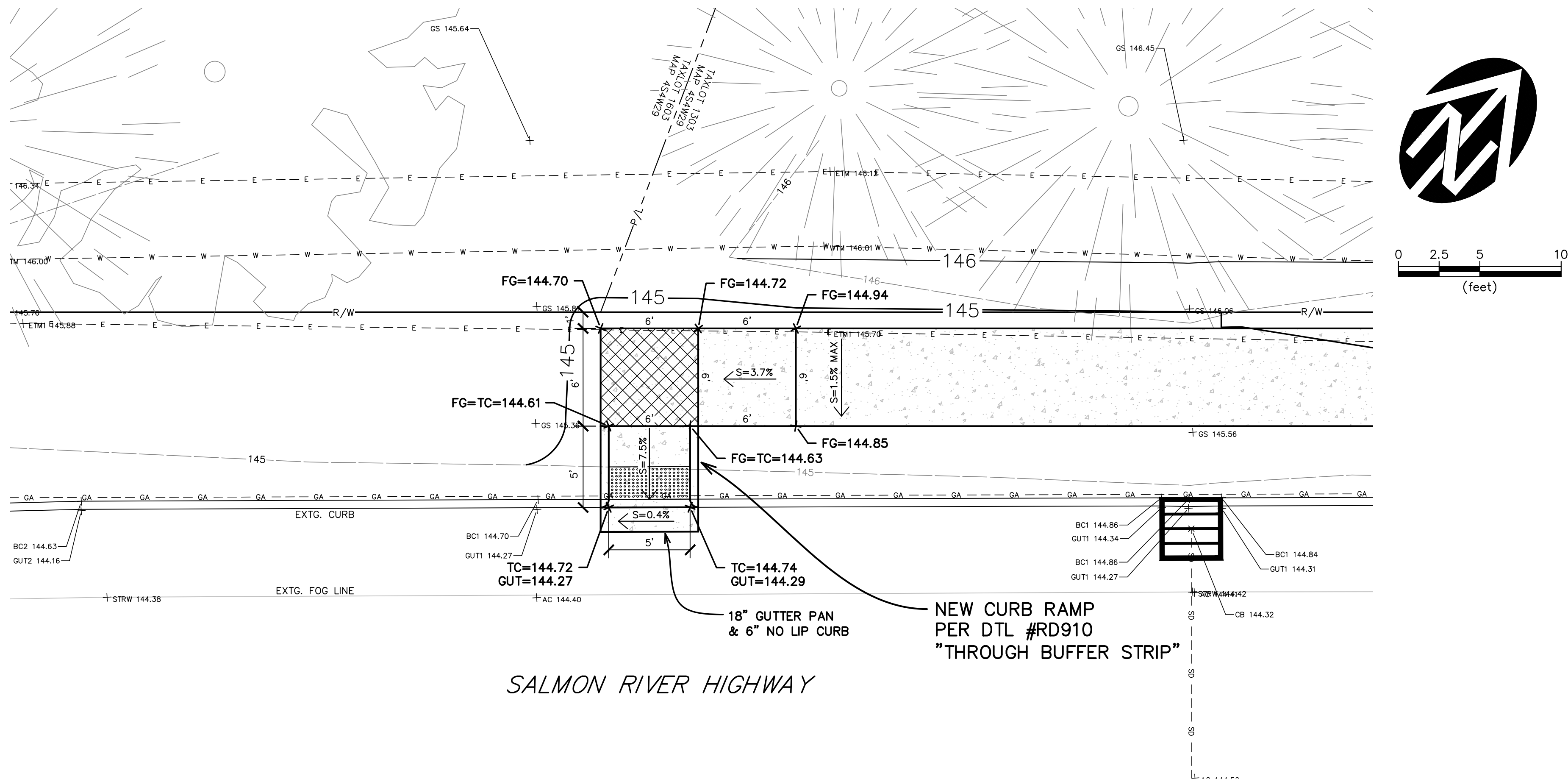

ENLARGED CURB RAMP DETAILS
1" = 5'

ADA LEGEND	
	= TRUNCATED DOMES SEE DTLS RD902--RD908
	= LEVEL SPACE SEE DTL RD901

revisions:	
1	8-23-23 ADDED SIDEWALK RAMP & DETAILS
2	9-6-23 PER ODOT COMMENTS

date: AUGUST 2023
project: 3445.1000.0
dwg file: C2.1
drawn by: TN
checked by: JW
copyright © 2023
Carlson Veit Junge Architects PC

07-SEP-2021

RD901.dgn

Linear Referencing Method (LRM) Number
Use ODOT TransG5, turn on layers Roadside > ADA corners and ADA Ramps to see LRM and corner position number of curb ramps inventoried. Select "Identify Features" and click on Map Position to see information.

This is a code to identify the intersection on a specific state highway.
There is a four part format for the code: Highway Number; Highway Suffix; Roadway ID, Mileage Type.

1) The Highway Number is a 3 digit number (not the route number) assigned to all state highways by ODOT.
Valid numbers are 001-493.

2) Highway Suffix is a letter format assigned to frontage roads and connections to identify the unique connection, for example AA or AB.
Use the Identify Features tool on the ODOT Trans G5 Road Network layer > Hwy Network- Colored layer for visual reference. Select "Identify Features" and click on Map Position to see information.
If the intersection is not located on a connection use 00 for the code.

3) Roadway ID is a one letter code used to identify alignment. There are two possible letter codes; "I" for increasing mile point direction and "D" for decreasing mile point direction.
For most highways, the "I" direction is south and east. Note I-5 does not follow this rule. Generally "I" will be used.
When there is a separated highway there will be an "I" roadway and a "D" roadway.
Check the Digital Video Log to be sure of the direction.

4) Mileage Type is used when there are multiple locations of the same mile point on a section of highway.
Overlay lapping mileage is listed as "2" mileage.

Example
Hwy No. 228, 00, I, 00
Suffix ID Type

Milepoint of an intersection is based on the mile point of the center of the intersection listed to the hundredth of a mile.

Corner Position is based on traveling in the increasing mile point direction, beginning with the first corner on the right and proceeding counter-clockwise around the intersection, numbering consecutive 1 through the end of corners. An "A" is added to the number for an island. For example an island between corner positions 1 and 2 and is closer to corner 2 has a corner position number of 2A (See corner position and curb ramp position diagram).

Curb Ramp Position is a number given to each curb ramp beginning with Corner Position 1. The first curb ramp encountered in the increasing mile point direction is number ramp 1. Then proceeds counter-clockwise around the corner, numbering in consecutive order. Proceed following the pedestrian route and in Corner Position Number order (see corner position and curb ramp position diagram).

STANDARD ABBREVIATION FOR CURB RAMP DETAILS

FG = Finish Grade (Elevation ft.) i.e. FG XXX.XX'
TFC = Top Face of Curb (Elevation ft.)
TBC = Top Back of Curb (Elevation ft.)
BFC = Bottom Face of Curb (Elevation ft.)
gtr. = Gutter (Elevation ft.)
GS = Gutter Slope (%), i.e. X.XX%
E = Curb Exposure (inch), i.e. X"
CS = Counter Slope on gutter pan (%)
RRN = Ramp Run Number, i.e. RRX
cl.sp. = Clear Space
TS = Turning Space
XS = Cross Slope
LA = Level Area
DWS = Detectable Warning Surface
PAR = Pedestrian Access Route

INTERSECTION CONDITION TYPES

MB = Midblock
SU = Signalized or Uncontrolled
SV = Stop or Yield

LEGEND:

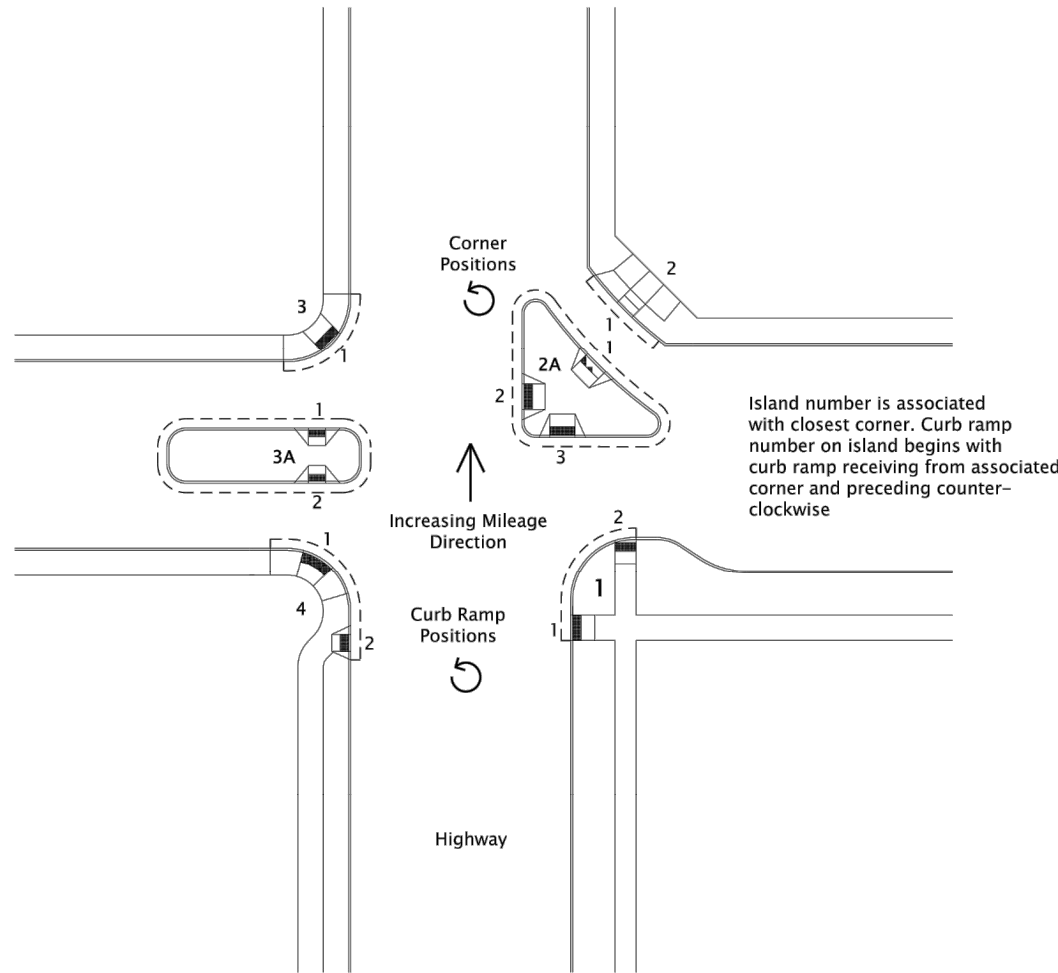
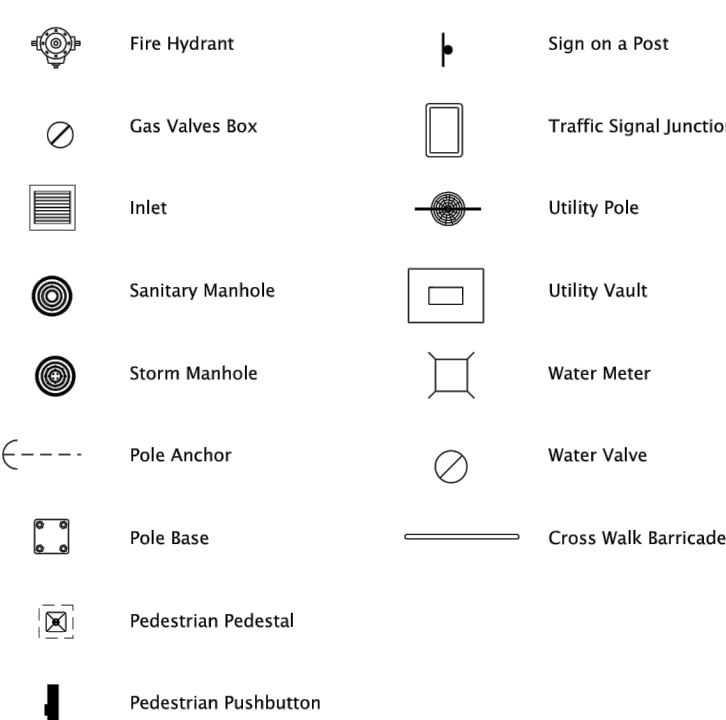

CORNER POSITION AND CURB RAMP POSITION DIAGRAM
(See ODOT Exhibit A for additional ramp and ramp run numbering conventions.)

All materials shall be in accordance with the current Oregon Standard Specifications.	
OREGON STANDARD DRAWINGS	
CURB RAMP LEGEND AND CORNER IDENTIFICATION	
2024	
DATE	REVISION DESCRIPTION
07-2020	NEW DRAWING CREATED
09-2021	REVISED NOTES
CALC. BOOK NO. N/A	
SDB DATE	14-JAN-2022
RD901	

Effective Date: December 1, 2023 – May 31, 2024

19-JUL-2021

RD902.dgn

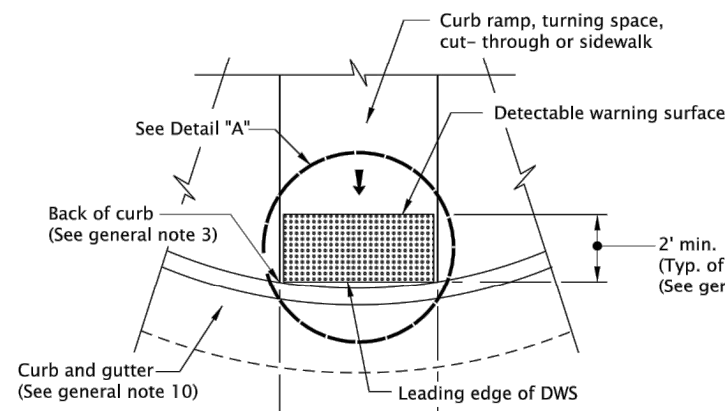

DETECTABLE WARNING SURFACE DETAIL

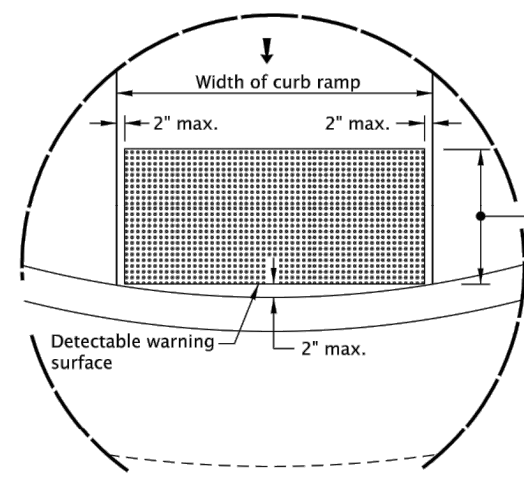

DETAIL "A"

	A	B	C	D	E
MIN.	1.60"	0.65"	0.45"	0.90"	0.20"
MAX.	2.40"	—	0.91"	1.40"	0.20"

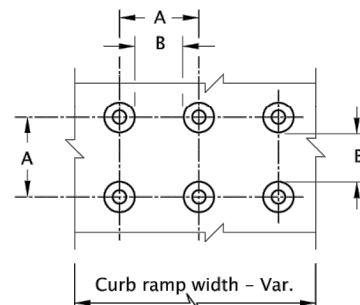

TRUNCATED DOME SPACING

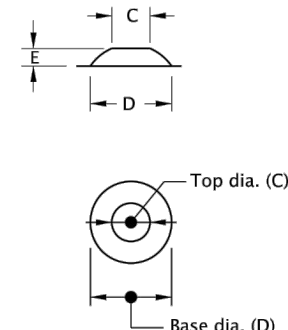

TRUNCATED DOME DETAILS

GENERAL NOTES FOR ALL DETAILS ON THIS SHEET:

- Detectable warning surface details & locations are based on applicable ODOT Standards.
- See project plans for details not shown.
See Std. Dwg. RD700 & RD701 for curbs.
- The detectable warning surface shall extend the full width of the curb ramp opening, shared use path, blended transition, turning space, or other roadway entrance as applicable. A gap of up to 2 inches on each side of the detectable warning surface is permitted (measured at the leading edge of the detectable warning surface panel as shown in Detail "A").
- Detectable warning surface shall be placed at the back of curb for a minimum depth of 2 ft. in the direction of pedestrian travel at curb ramps that are adjacent to traffic. Detectable warning surface may be radial or rectangular, but must comply with the truncated dome size and spacing standards. Detectable warning surface may be cut to meet necessary shape as shown in plans. Detectable warning surface across a grade break is prohibited. Place abutting panels within 1/4 inch of each other and install anchors, as specified by manufacturers, along cut edge.
- Color to be safety yellow if no color specified in construction note. Alternative colors require a design exception on or along state highways.
- Detectable warning surface shall be used in the following locations:
a) Curb ramps at street crossings.
b) Crossing islands (Accessible Route Islands).
c) Rail crossings.
- Where public transportation stations (rail, bus, etc.) use platform boarding, detectable warning surface shall be placed along the full edge length of the station, when not protected by platform screens or guards, (see Std. Dwg. RD900).
- Detectable warning surface shall not be used on the following locations:
a) End of sidewalk transitions that are not at a crosswalk, (see Std. Dwg. RD950, RD952 and RD960).
b) Driveways, unless constructed with curb return or are signalized.
c) Parking lots, access aisles and passenger loading zones where curb ramp does not lead to vehicular way.
- Where no curb is present, the detectable warning surface shall be placed at the edge of the roadway.
- On or along state highways, curb and gutter is required at curb ramps.

LEGEND:

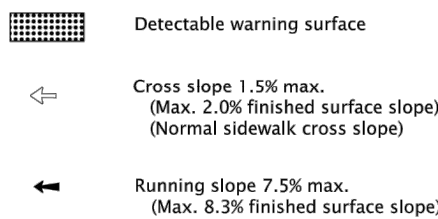

The selection and use of this Standard Drawing, while designed in accordance with generally accepted engineering principles and practices, is the sole responsibility of the user and should not be used without first consulting a Registered Professional Engineer.

All materials shall be in accordance with the current Oregon Standard Specifications.	
OREGON STANDARD DRAWINGS	
DETECTABLE WARNING SURFACE DETAILS	
2024	
DATE	REVISION DESCRIPTION
07-2020	NEW DRAWING CREATED
07-2021	REVISED DETAILS AND NOTES
CALC. BOOK NO. N/A	
SDB DATE	19-JUL-2021
RD902	

Effective Date: December 1, 2023 – May 31, 2024

20-JUL-2020

RD904.dgn

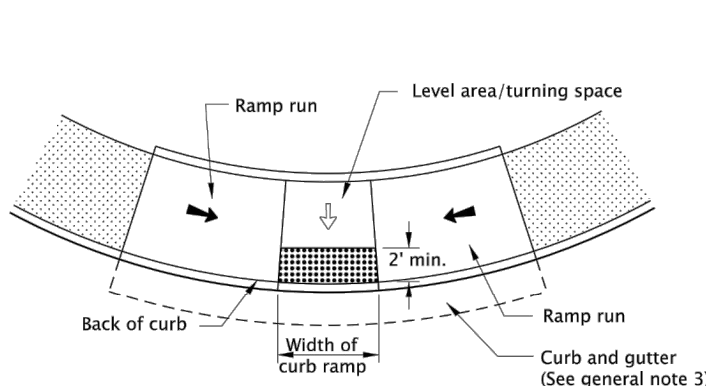

PARALLEL CURB RAMP

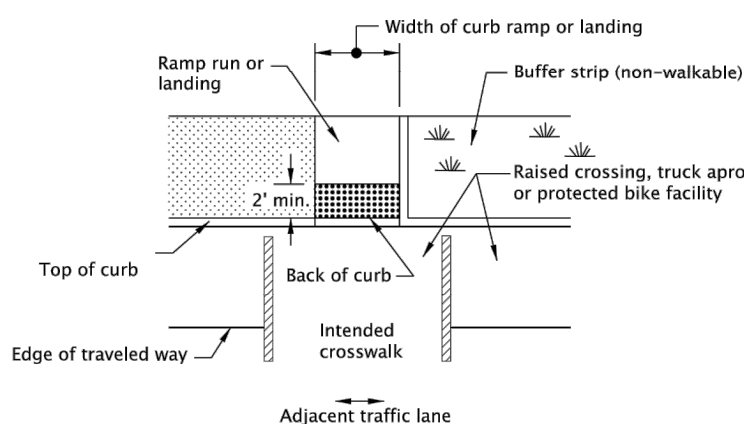

RAISED CROSSING, TRUCK APRON OR PROTECTED BIKE FACILITY

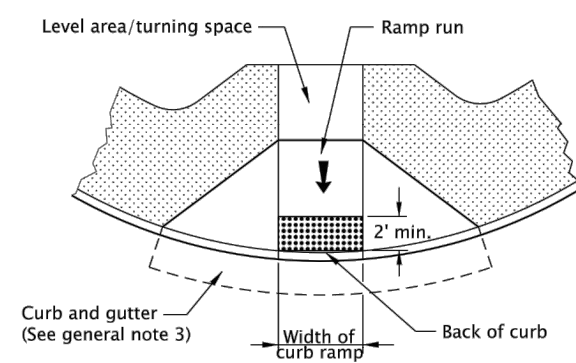

PERPENDICULAR CURB RAMP
GRADE BREAK IN FRONT OF CURB

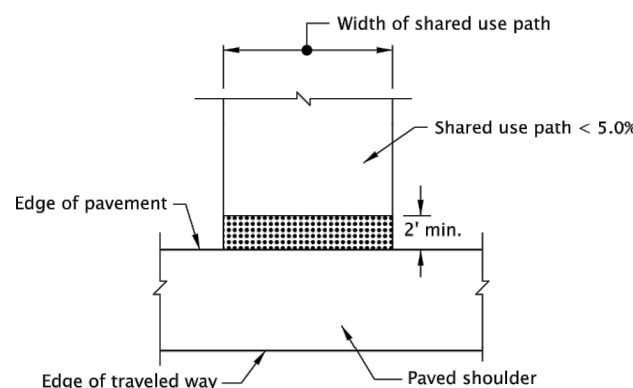

SHARED-USE PATH CONNECTION

GENERAL NOTES FOR ALL DETAILS ON THIS SHEET:

- Detectable warning surface details & locations are based on applicable ODOT Standards.
- See project plans for details not shown.
See Std. Dwg. RD700 & RD701 for curbs.
See Std. Dwg. RD902 for detectable warning surface installation details.
- On or along state highways, curb and gutter is required at curb ramps.
- Detectable warning surface placement for perpendicular ramps vary as shown.

LEGEND:

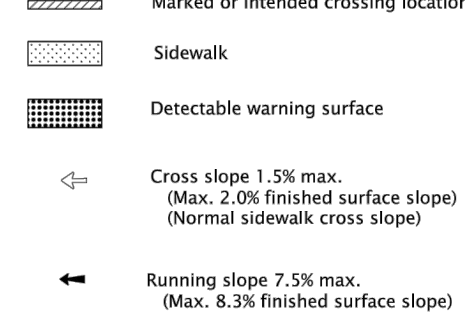

The selection and use of this Standard Drawing, while designed in accordance with generally accepted engineering principles and practices, is the sole responsibility of the user and should not be used without first consulting a Registered Professional Engineer.

All materials shall be in accordance with the current Oregon Standard Specifications.	
OREGON STANDARD DRAWINGS	
DETECTABLE WARNING SURFACE PLACEMENT FOR CURB RAMPS	
2024	
DATE	REVISION DESCRIPTION
07-2020	NEW DRAWING CREATED
CALC. BOOK NO. N/A	
SDB DATE	20-JUL-2020
RD904	

Effective Date: December 1, 2023 – May 31, 2024

14-JAN-2022

RD905.dgn

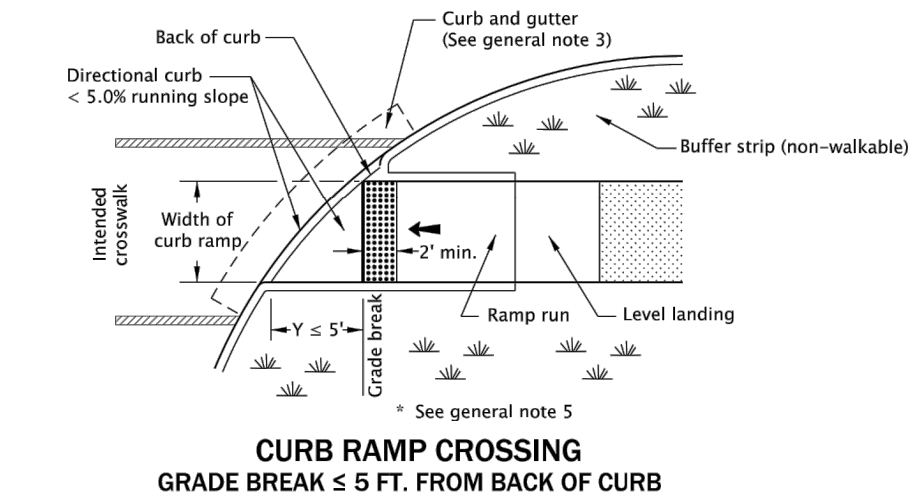

CURB RAMP CROSSING
GRADE BREAK ≤ 5 FT. FROM BACK OF CURB

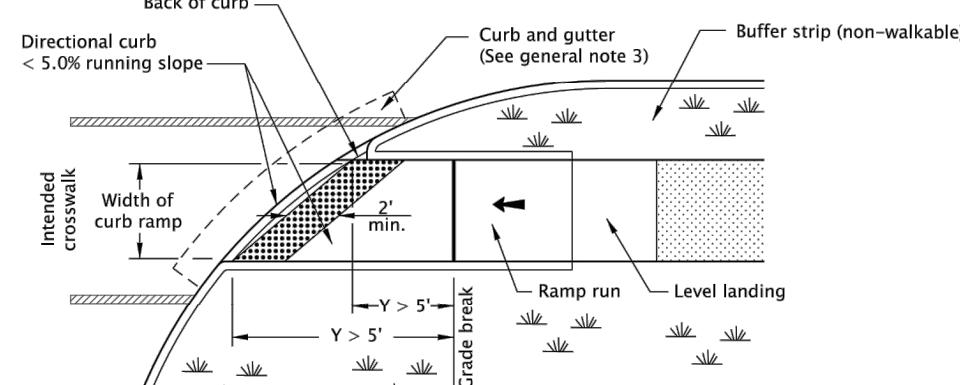

CURB RAMP CROSSING
GRADE BREAK > 5 FT. FROM BACK OF CURB

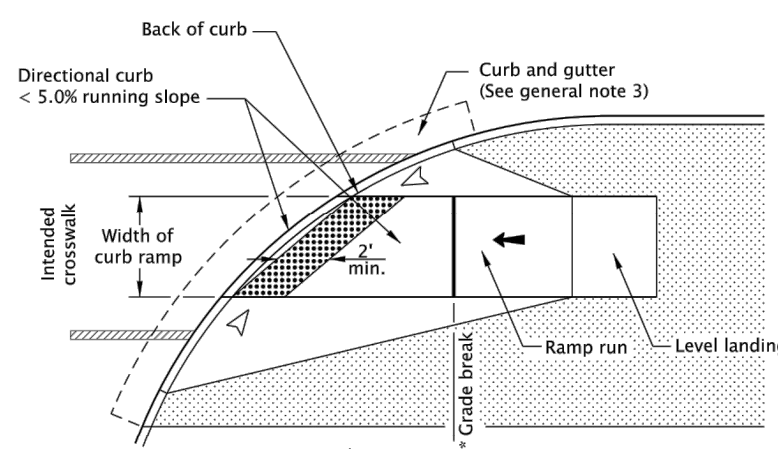

CURB RAMP CROSSING
DIRECTIONAL CURB WITH FLARED CONSTRUCTION

GENERAL NOTES FOR ALL DETAILS ON THIS SHEET:

- Detectable warning surface details & locations are based on applicable ODOT Standards.
- See project plans for details not shown.
See Std. Dwg. RD700 & RD701 for curbs.
See Std. Dwg. RD902 for detectable warning surface installation details.
- On or along state highways, curb and gutter is required at curb ramps.
- Detectable warning surface placement for perpendicular ramps vary as shown.
- Detectable warning surface placement across the grade break is prohibited.

LEGEND:

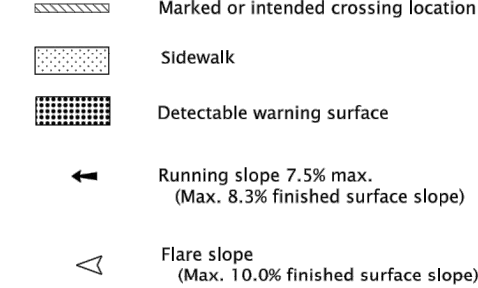

The selection and use of this Standard Drawing, while designed in accordance with generally accepted engineering principles and practices, is the sole responsibility of the user and should not be used without first consulting a Registered Professional Engineer.

All materials shall be in accordance with the current Oregon Standard Specifications.	
OREGON STANDARD DRAWINGS	
DETECTABLE WARNING SURFACE PLACEMENT FOR DIRECTIONAL CURBS	
2024	
DATE	REVISION DESCRIPTION
07-2020	NEW DRAWING CREATED
01-2022	REVISED NOTES
CALC. BOOK NO. N/A	
SDB DATE	14-JAN-2022
RD905	

Effective Date: December 1, 2023 – May 31, 2024

CARLSON
VEIT
JUNGE
ARCHITECTS PC

ARCHITECTURE • INTERIOR DESIGN
3095 RIVER RD N. SALEM, OREGON 97303
WWW.CARLSONVEIT.COM • 503-390-0281



project:
WILLAMETTE EDUCATION SERVICE DISTRICT
YAMHILL CENTER SIDEWALK IMPROVEMENTS
2045 SW HIGHWAY 18
MCMINNILLE, OR 97328

WESTECH ENGINEERING, INC.
CONSULTING ENGINEERS AND PLANNERS

3941 Fairview Industrial Dr. S.E., Suite 100, Salem, OR 97302
Phone: (503) 585-2474 Fax: (503) 585-3986
E-mail: westech@westech-eng.com

revisions:
2 9-6-23
PER ODOT COMMENTS

date: AUGUST 2023
project: 3445.1000.0
dwg file: C4.3
drawn by: TN
checked by: JW
copyright © 2023
Carlson Veit Junge Architects PC

DETAILS

sheet:

C4.3

of:

RD906.dgn
20-JUL-2020

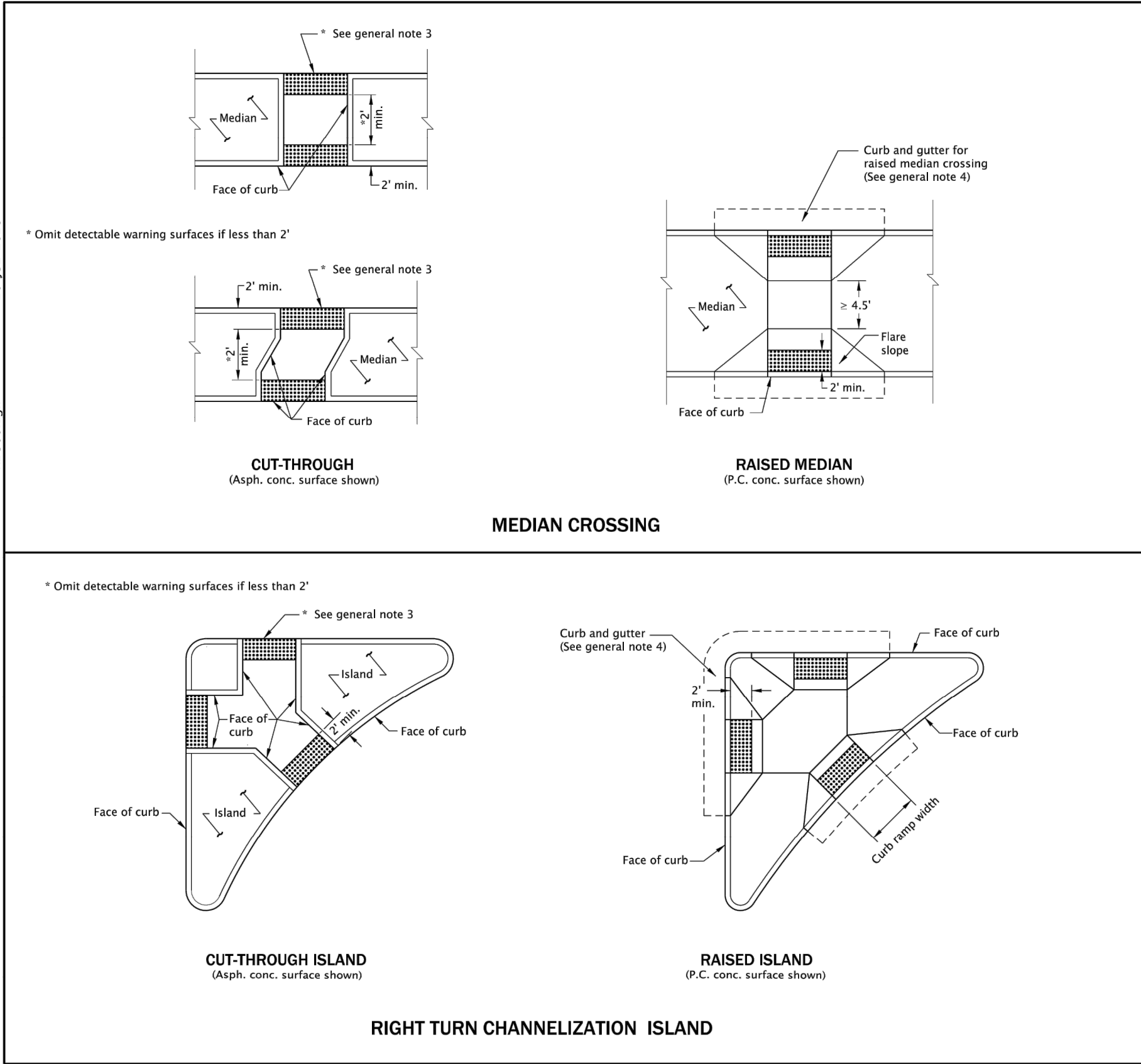

GENERAL NOTES FOR ALL DETAILS ON THIS SHEET:

- Detectable warning surface details & locations are based on applicable ODOT Standards.
- See project plans for details not shown. See Std. Dwg. RD700 & RD701 for curbs. See Std. Dwg. RD710 & RD711 for accessible route island. See Std. Dwg. RD902 for detectable warning surface installation details.
- Detectable warning surfaces shall be separated by a 2.0 ft minimum length of walkway without detectable warnings. Where the island has no curb, the detectable warning surface shall be placed at the edge of roadway.
- On or along state highways, curb and gutter is required at curb ramps.
- Details intended for pedestrian route only. For protected bike lanes on multi-use paths, see project plans for specific details.

LEGEND:

Detectable warning surface

The selection and use of this Standard Drawing, while designed in accordance with generally accepted engineering principles and practices, is the sole responsibility of the user and should not be used without first consulting a Registered Professional Engineer.

All materials shall be in accordance with the current Oregon Standard Specifications.			
OREGON STANDARD DRAWINGS			
DETECTABLE WARNING SURFACE			
PLACEMENT FOR			
ACCESSIBLE ROUTE ISLAND			
2024			
DATE	REVISION	DESCRIPTION	
07-2020		NEW DRAWING CREATED	
CALC.	RD906	N/A	DATE 20-JUL-2020
RD906			

Effective Date: December 1, 2023 – May 31, 2024

RD908.dgn
15-JUL-2022

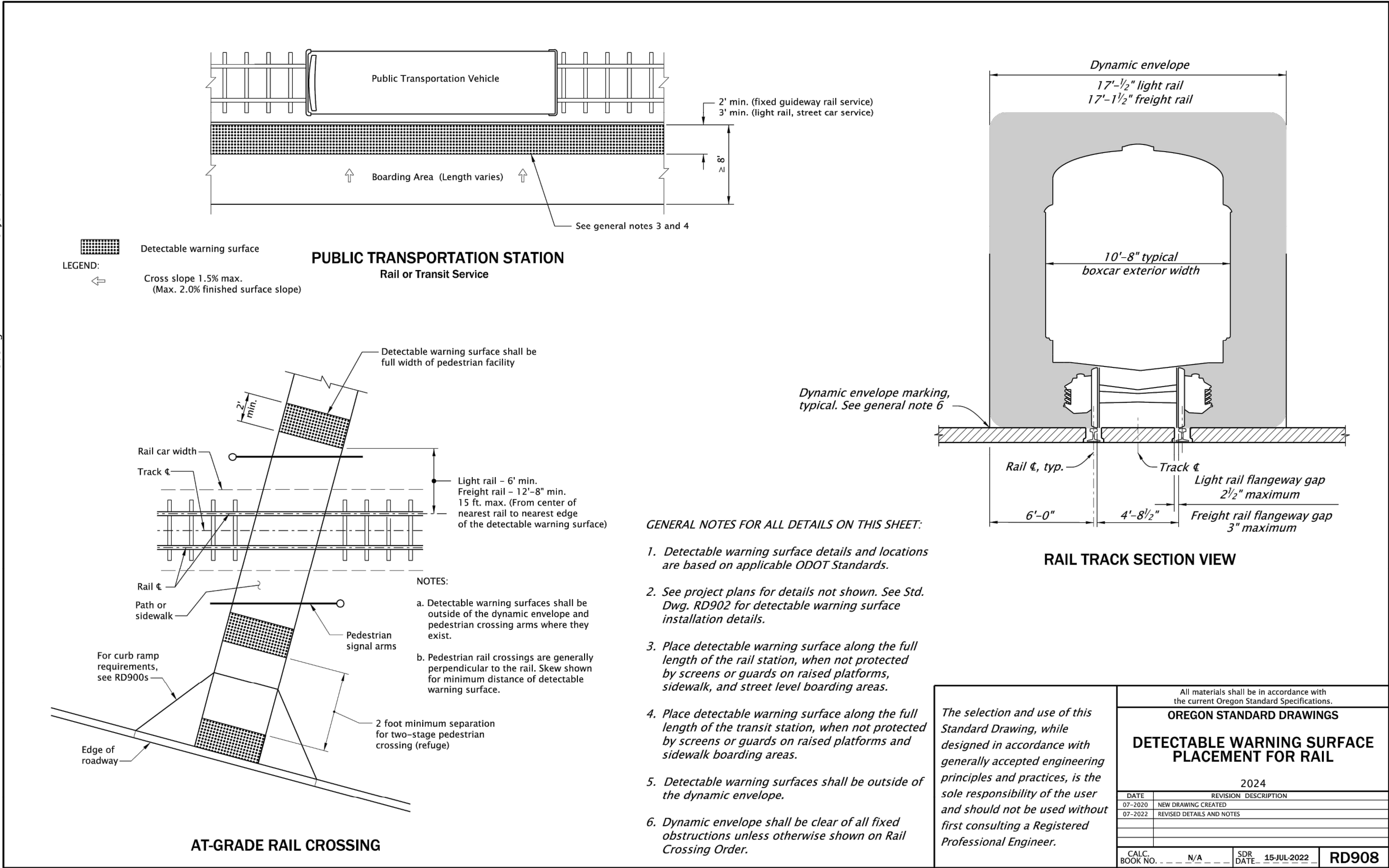

Effective Date: December 1, 2023 – May 31, 2024

project:
WILLAMETTE EDUCATION SERVICE DISTRICT
YAMHILL CENTER SIDEWALK IMPROVEMENTS
2045 SW HIGHWAY 18
MCMINNILLE, OR 97328

consultants:
WESTTECH ENGINEERING, INC.
CONSULTING ENGINEERS AND PLANNERS
3941 Fairview Industrial Dr. S.E., Suite 100, Salem, OR 97302
Phone: (503) 585-2474 Fax: (503) 585-3986
E-mail: westtech@westech-eng.com

revisions:
2 9-6-23
PER ODOT COMMENTS

date: AUGUST 2023
project: 3445.1000.0
dwg file: C4.4
drawn by: TN
checked by: JW
copyright © 2023
Carlson Veit Junge Architects PC

DETAILS

sheet:
C4.4
of:

CARLSON VEIT JUNGE ARCHITECTS PC
ARCHITECTURE • INTERIOR DESIGN
3095 RIVER RD N. SALEM, OREGON 97303
WWW.CARLSONVEIT.COM • 503-390-0281

REGISTERED PROFESSIONAL ENGINEER
76415PE
DIGITALLY SIGNED
OREGON NOV 12, 2008
WILLIAM J. WELLS
RENEW: 6/30/2024



**THE WILAMETTE EDUCATION SERVICE DISTRICT
SIDEWALK IMPROVEMENT PROJECT
YAMHILL CENTER
Bids Due 2:00 PM, November 30, 2023**

INVITATION FOR BIDS

NOTICE IS HEREBY GIVEN that sealed bids will be accepted at **the Willamette Education Service District, Yamhill Center, by Jeff Easter, Director of Facilities and School Safety, located at 2045 SW Highway 18, Suite 100, McMinnville, OR 97128** at which time and place bids will be closed. The bids will be publicly opened and read immediately after closing.

The work consists of: General sidewalk improvements along the Salmon River Highway and Booth Bend Road conforming to the Oregon Standard Specifications for Construction (OSSC/ODOT/APWA).

The following deadlines and restrictions are applicable to the project: Project start date **Date of Notice to Proceed**. Contract must meet a Substantial Completion date of **January 23, 2024**.

A MANDATORY Pre-Bid Meeting will be held at 2:00 PM on November 2, 2023 located at the Yamhill Center located at 2045 SW Highway 18, Suite 100, McMinnville, OR 97128. Representatives of the Contractors will meet with the Owner and Project Manager for review of the project specifications and then visit the site for a walk of the facility.

All bids must be submitted on the bid forms furnished to the bidders. Each bid shall be submitted in a sealed envelope and plainly marked **“WESD – YAMHILL CENTER SIDEWALK IMPROVEMENT PROJECT”** and show the name and business address of the bidder. Each bid must be accompanied by an unconditional cashier's check, certified check or surety bond of the bidder in the amount of ten percent (10%). Unsuccessful bidders will have their security refunded to them when the contract has been awarded.

Bid documents may be obtained from HMK Company web site <https://www.hmkco.org/bid-documents/>.

Any objections to or comments upon the bid specifications must be submitted in writing to the attention of Jeff Easter, Director of Facilities and School Safety, Willamette Education Service District, 2611 Pringle Road SE, Salem, OR 97302-1533. To be considered, such objections or comments must be received at least FIVE (5) working days before the bid closing date.

This contract is for a public work subject to ORS 279C.800 to 279C.870 (the Oregon Prevailing Wage Rate Law). **BOLI wage rates will be applicable to this project.** The wage rates are included in the bid documents which are available as noted above.

No bid for a construction contract shall be received or considered by the public contracting agency unless the bidder is licensed by the Construction Contractors Board of the State of Oregon as required by ORS 701.035 and 701.055. Each bid must identify whether the bidder is an Oregon resident bidder, as defined in ORS 279A.120.

Bidder's attention is directed to compliance with ORS 279C.370 regarding submission of the First-Tier Subcontractor Disclosure Form. If the contract amount exceeds \$100,000.00, the First-Tier Subcontractor Disclosure Form will be required and may be submitted either with the bid or within **two (2)** hours after the bid closing time and date at the bid site address. Failure to provide the First-Tier Subcontractor Disclosure Form may result in bid rejection.



WILLAMETTE EDUCATION SERVICE DISTRICT
YAMHILL CENTER
SIDEWALK IMPROVEMENT PROJECT
INVITATION FOR BID
SECTION 00 1113

The Willamette Education Service District reserves the right to reject any or all bids, to waive formalities, and to postpone the award of the contract for thirty (30) days. All bids and all prices quoted in bids shall be firm for a period of thirty (30) days after the bid closing date.

Dated this October 9, 2023

Jeff Easter
Director of Facilities and School Safety
Willamette Education Service District



PART 1 – GENERAL

1.1 GENERAL

- A. The Work contemplated under this contract with the Willamette Education Service District, (also referred to as the Owner or the District), includes all labor, materials, transportation, equipment and services necessary for, and reasonably incidental to, the completion of all Work in connection with the project described in the bidding documents.

- B. A brief summary of the Work to be completed for the District is as follows:

The project is the general sidewalk improvements along the Salmon River Highway and Booth Bend Road conforming to the Oregon Standard Specifications for Construction (OSSC/ODOT/APWA).

1.2 EXAMINATION OF SITE AND CONDITIONS

- A. Prior to submitting a bid, the bidder shall examine the facilities, and ascertain all of the physical conditions in relation thereto. The bidder shall also make a careful examination of the drawings, specifications and other contract documents and shall fully inform himself as to the quantity of materials and the sources of supply of the materials. Failure to make these precautions will not release the successful bidder from entering into a contract or excuse him from performing the Work in strict accordance with the terms of the contract.

- B. The Owner will not be responsible for any loss or any unanticipated costs that may be suffered by the successful bidder as a result of such bidder's failure to fully inform himself in advance with regard to all conditions pertaining to the Work and the character of the Work required. No statement made by any officer, agent or employee of the Owner in relation to the physical conditions pertaining to the site of the Work will be binding on the Owner.

1.3 INTERPRETATION OF CONTRACT DOCUMENTS

- A. If any person contemplating submitting a bid for the proposed contract finds discrepancies in, or omission from, or is in doubt as to the true meaning of any part of the drawings, specifications or form of contract documents, they may submit to the Architect a written request for an interpretation thereof to be received in the office of the Architect no later than **7 calendar days before bid, before 2:00 PM** local time. The person submitting the request will be responsible for its delivery prior to the time of closing.

- B. Any official interpretation of the drawings, specifications, and conditions of the contract or forms of contract documents will be made only by subsequent addenda issued by the Project Manager. The Owner will not be responsible for any other explanation or interpretation of the proposed documents.

1.4 SPECIFIED PRODUCTS AND SUBSTITUTIONS

- A. Bids must be based upon the use of items and manufacturers named in the specifications, or, approved equals issued by addenda during the bidding period. Approval of equals or substitutions must not be assumed.



- B. If a prospective bidder or supplier seeks approval of a particular manufacturer's material or product other than the material, product and / or manufacturer designated in the specifications, he may submit a written request for such substitute material, product and / or manufacturer. Substitution requests are to be submitted using the Substitution Request Form included in this project manual. Substitution requests must be received in the office of the architect no later than **7 calendar days before bid, before 2:00 PM** local time. The person requesting the substitution will be responsible for delivery of the substitution request form prior to the time of closing. **Emailed Substitution Request Forms will be accepted by Jeff Easter, Director of Facilities and School Safety, at jeff.easter@wesd.org.**
- C. Approval of substitution requests will be made only by addenda issued by the Project Manager during the bidding period. The Owner will not be responsible for any other approval of a particular manufacturer's materials.

1.5 PRE-BID MEETING

- A. A MANDATORY Pre-Bid Meeting will be held at Time 2:00 PM on November 2, 2023 at the **Yamhill Center located at 2045 SW Highway 18, Suite 100, McMinnville, OR 97128**. Representatives of the Contractors will meet with the Owner and Project Manager at the site for review of the project specifications and site walk of the facility.
- B. Contractors intending to submit proposals for this project must attend this pre-bid meeting. No other meeting will be held.

1.6 GENERAL STATUTORY PROVISIONS CONCERNING PUBLIC CONTRACTS

- A. In accordance with the provisions of Oregon Revised Statutes (ORS) 279C.530, it is agreed that the Contractor shall make prompt payment, as due, to all person supplying to the contractor labor or materials for the prosecution of the Work provided for herein, pay all contributions or amounts due the State Industrial Accident Fund from the Contractor incurred in the performance of the contract herein, not permit any lien or claims to be file or prosecuted against the District on account of any labor or material furnished, and to pay the State Tax Commission all sums withheld from employees pursuant to ORS 316.169, ORS 316.189 and ORS 316.167.
- B. Pursuant to ORS 279C.515, it is agreed that if the Contractor fails, neglects or refuses to make prompt payment on any claim for labor or services furnished to the Contractor by any persons in connection with this agreement as such claim becomes due, the proper officer of officers representing the District may pay such claim to the person furnishing the labor or service and charge the amount of the payment against the Contractor. The payment of a claim in the manner authorized in this paragraph shall not relieve the Contractor or his surety from obligation with respect to any unpaid claims.
- C. Pursuant to ORS 279C.520, it is a condition of this agreement that no person shall be employed by the Contractor for more than eight (8) hours in any one (1) day, or forty hours in any one (1) week, except in cases of necessity, emergency or where the public policy absolutely requires it, and in such cases, the person shall be paid at least time and a half pay for all overtime in excess of eight (8) hours in any one (1) day and for Work performed on Saturdays and legal holidays.
- D. Pursuant to ORS 279C.525 the Contractor shall comply with the provisions of all



federal, state and local statutes, ordinances and regulations dealing with the prevention of environmental pollution and the preservation of natural resources that affect the project.

- E. Pursuant to ORS 279C.530, it is an express condition of this agreement that the Contractor shall, promptly, as due, make payment to any person, co-partnership, association or corporation furnishing medical, surgical and hospital care or other needed care and attention, incident to sickness or injury, to the employees of such Contractor, or all sums which the Contractor may or shall have deducted from their wages of his employees for such services pursuant to the terms of ORS 279B.230, and any contract entered into pursuant thereto, or collected or deducted from the wages of its employees pursuant to any law, contract or agreement for the purposes of providing or paying for such service.
- F. The hourly rate of wage to be paid by the Contractor (and incorporated in his subcontracts) shall not be less than provided in ORS 279C.800 to ORS 279C.870, and as hereinafter included in Section 00 7343-BOLI Wage Rate Requirements.
- G. Pursuant to ORS 645.001 et seq. OAR Chapter 437, Div. 3 and OAR Chapter 437-002-0320 through OAR Chapter 437-002-0325, the Contractor shall comply with the following conditions under any contract to provide the District with goods or services.
 - 1. Contractors and their employees shall comply with the requirements of the above cited Laws, Rules, Policies and Regulations
 - 2. The Contractor shall review the Material Safety Data Sheets filed by the District to determine if there are any chemicals stored at the site of Work which the Contractor or any subcontractors will use, or could be exposed to in an emergency
 - 3. Workers shall inform the executive officer at the location where services are being performed of all hazardous chemicals which they or their subcontractors bring upon education facility property, and upon request, provide the District with M.S.D.S. for such chemicals
- H. Each bid shall identify whether the bidder is an Oregon resident bidder, as defined in ORS 279A.120.
- I. Pursuant to ORS 279C.830 (3), the contractor and every subcontractor must have a public works bond filed with the Construction Contractors Board before starting work on the project, unless exempt under ORS 279C.836 (4), (7), (8) or (9).

1.7 BID SECURITY

- A. No bid will be considered unless accompanied by a cashier's check or bid bond executed in favor of the District and associated facility for an amount equal to at least ten percent (10%) of the base bid and shall accompany the bid as evidence of good faith and as guarantee that if awarded the contract the bidder will execute the contract and provide a performance bond and payment bond as required. The successful bidder's check or bid bond will be retained until the bidder has entered into a satisfactory contract and furnished a 100% performance bond and payment bond. The Owner reserves the right to hold the bid security as hereinafter noted.



- B. The bid bond shall be furnished by a bonding company licensed to do business in the State of Oregon.
- C. Should the successful bidder fail to execute and deliver the signed agreement and a satisfactory payment bond and performance bond within ten (10) days after the bid has been accepted by the Owner, the cashiers check or bid bond may be forfeited as liquidated damages at the option of the Owner. The date of acceptance of the bid and the award of the contract as contemplated by the contract documents shall mean the day on which the Owner takes official action in making the award.

1.8 EXECUTION OF THE BID FORM

- A. The bid form invites bids on definite drawings and specifications. Only the amounts and information asked for on the bid form furnished will be considered as the bid. Each bidder shall bid upon the Work exactly as specified and provided in the bid form. The bidder shall include in a sum to cover the cost of all items contemplated by the bidding documents.
- B. The bid form included in the project manual as Document 00 4100 is the official bid form that will be used in submitting a bid. Only the official bid form may be used in submitting a bid.
- C. All blank spaces in the official bid form shall be filled and numbers shall be stated both in writing and in figures. If the bid is made by a partnership, it shall contain the names of each partner and shall be signed in the firm name, followed by the signature of the partner signing for the firm. The address of the bidder shall be typed or printed on the bid form.
- D. Bids which are incomplete, or which are conditioned in any way, or which contain erasures or alterations may be rejected.

1.9 SUBMISSION OF BID

- A. The bid proposal shall be sealed in an opaque envelope, addressed as follows:

BID PROPOSAL
Yamhill Center Sidewalk Improvement Project
Willamette Education Service District
2045 SW Highway 18, Suite 100
McMinnville, Oregon 97128
Attn: Jeff Easter, Director of Facilities and School Safety
- B. Bids will be received up to 2:00 pm, local time, **November 30, 2023** at the address listed above.
- C. Any bid submitted after the scheduled closing time will be returned to the bidder unopened.

1.10 OPENING OF BIDS

- A. A public bid opening will be held immediately following the scheduled closing. Each and every bid received prior to the closing time will be publicly opened and read aloud irrespective of any irregularities or informalities contained in such bids.



1.11 DURATION OF BID PROPOSALS

- A. The base bid shall be irrevocable for a period of sixty (60) days from the date and time of bid opening.
- B. The base bid may be adjusted for alternate prices and / or unit prices for a period of sixty (60) days from the date and time of bid opening.

1.12 CONTRACT AND BOND

- A. Within ten (10) days after receipt of Notice of Award, any bidder to whom a contract is awarded shall execute a formal written contract and shall furnish corporate surety bonds with a surety company satisfactory to the District in an amount equal to the full contract sum based upon the estimated quantities of items covered by the contract for the faithful performance of said contract and all provisions thereof; provided, the formation of said contract shall not be completed and the District shall not be liable thereon until said formal written contract has been executed both by the successful bidder and by the District and a performance bond and a payment bond, properly executed has been delivered and accepted by the District.
- B. The cashiers check or bid bond of the bidder with whom a contract is entered into will be returned when said contract has been properly executed by the bidder and said performance and payment bond, properly executed, has been delivered to and accepted by the District. The cashiers check or bid bond to each bidder who was not awarded a contract will be returned promptly after the contract and bond of the successful bidder, properly executed, has been delivered to and accepted by the District.
- C. Any bidder to whom a contract is awarded and who shall default in executing said formal written contract or in furnishing a satisfactory performance and payment bond within the time and in the manner required by these specifications shall be liable to the District for whatever damages, including expenses and attorney's fees as may be incurred by the District in recovering to another bidder whether by a single action or by successive actions, shall not operate to release any defaulting bidder from said liability. The parties agree that the cashiers check or bid bond amount is fair determination of the amount of damages which the District would incur as a result of any such failure on the part of the bidder and the full amount will be forfeited as liquidated damages and will not constitute a penalty. In the event competent tribunal finds that this amount does not properly represent an award of liquidated damages, expenses and attorney's fees incurred by the District as a result of the bidder's default, then the final determination of the tribunal shall be deemed to represent the damages, expenses and attorney's fees incurred by the District as a result of the bidder's default.

1.13 SUBSTANTIAL COMPLETION AND LIQUIDATED DAMAGES

- A. Substantial Completion shall occur at **March 1, 2024**.
- B. Should the building not be ready for occupancy by the time and date listed above, liquidated damages to be paid by the Contractor to the Owner for each calendar day of delay, shall be included in the terms of any contract awarded hereunder in lieu of a penalty. The amount of liquidated damages shall be \$1,000.00 per day.



1.14 DISTRICT PERSONNEL EXCLUDED FROM THE CONTRACT

- A. No officer, agent or employee of the District shall be permitted any interest in the contract.

1.15 RESERVATIONS

- A. The Board of Directors of Willamette Education Service District, expressly reserves the following rights:
 - 1. To reject all bids
 - 2. To waive any or all irregularities in bids submitted
 - 3. To consider the responsibility and competency of bidders in making any award
 - 4. In the event two or more bids shall be for the same amount for the same Work, to award the contract by lot or otherwise as it deems appropriate
 - 5. To award contract to one Contractor with the aggregate low bid
 - 6. To reject any bid or bids not in compliance with prescribed bidding procedures and requirements
 - 7. To reject any bid or bids not meeting the specifications set forth herein
 - 8. In the event any bidder to whom a contract is awarded shall default in executing said formal contract or in furnishing a satisfactory performance and payment bond within the time and in the manner herein before specified, to re-award the contract to another bidder.
 - 9. To accept Alternates in any order or combination, and to determine the low Bidder on the basis of the sum of the Base Bid and Alternates accepted.

1.16 ACCEPTANCE OF CONDITIONS

- A. Each bidder by submission of a bid assents to each and every term and condition set forth anywhere in these contract documents and agrees to be bound thereby.

1.17 INTERPRETATION UPON CONTRACT DOCUMENTS

- A. Only the Board of Directors of the Willamette Education Service District as represented by the Project Manager has authority to place any interpretation upon the foregoing or annexed contract documents. Any interpretation, either verbal or written, attempted to be placed thereon by any other person will not be binding upon the District.

1.18 EQUAL EMPLOYMENT

- A. All bidders shall comply with the Provision of Executive Order 1246 (30 F.R. 12319-25) regarding Equal Employment Opportunity.

1.19 IMMIGRATION REFORM AND CONTROL ACT



- A. All bidders shall comply with the provisions of the Immigration Reform and Control Act of 1986 regarding the verification of employment eligibility.

1.20 REFERENCES REQUIREMENTS

- A. All bidders shall provide a list of three different project references for projects that the Contractor worked on within the last three years of comparable size and scope. **References must be submitted with the Bid From.**
- B. Bidders shall use their own form to supply their list of references. The list of project references shall include the following information:
 - 1. Name of the Project
 - 2. Project description
 - 3. Project location
 - 4. Project date
 - 5. Dollar value of the Project
 - 6. Name of the project contact person
 - 7. Telephone number for contact person
 - 8. Email for contact person
- C. The references will be checked to determine if they are supportive of the bidder's ability to meet the requirements of this ITB.
- D. The bidder must provide references that can be contacted regarding the quality of workmanship, level of service provided, timeliness of completion, and adherence to specifications.
- E. The District reserves the right to choose and investigate any reference whether or not furnished by the bidder, and to investigate past performance of any bidder with respect to its successful performance on similar projects, its completion or delivery of service on schedule, and its lawful payment of suppliers, Subcontractors, and employees.
- F. The District may postpone the award or execution of the Contract after the announcement of the apparent successful Contractor in order to complete its investigation. The District may reject a bid if, in the opinion of the District the overall reference responses indicate inadequate performance of the Contractor.
- G. The District representative will make three attempts to contact the references from the list provided by the Contractor. If the reference is not contacted after three attempts that reference will be removed from the list and the bid rejected as non-responsive.
- H. Each reference contacted shall be asked the same questions, including but not limited to: (1) quality of service; (2) delivery; (3) responsiveness to reported problems, including orders and billing; (4) how well the Contractor met the terms of the contract; and (5) whether or not the reference would choose to hire the Contractor again.



1.21 CRIMINAL HISTORY CHECK / PHOTO ID

- A. It is the responsibility of the Contractor to submit the names of all Contractor employees and all Subcontractor employees who will be on the job site for more than one day. These employees shall fill out a criminal history form provided by the District and the Contractor must submit the completed forms to HMK Company (HMKCO). Criminal history checks will be run through the Oregon State Police as provided for in ORS 326.603. The District shall bear the cost of processing such Criminal history checks.
 - 1. Through the signature on the criminal history form, authorization is also given to HMK Company and its representative to investigate this information. Further, with this signature, consent is given to all governmental agencies, public or private companies and individuals to release information regarding the individual to the HMK Company and to their representative. The District shall bear the cost of processing such Criminal history checks.
- B. In accordance with ORS 326.603(8) the District is required to terminate the employment or contract status of any individual who refuses to consent to a criminal history check or to be fingerprinted or falsely swears to the non-conviction of any crime.
- C. In accordance with ORS 326.603(7)(a) no individual found to have been convicted of any crime listed in ORS 342.143 or of an attempt to commit one of the listed crimes shall be allowed to work on any District site.
 - 1. It is vital that employees are instructed to accurately complete criminal history forms. Crimes listed in ORS 342.143 which automatically bar an individual from employment with or contracting with the District are primarily crimes of violence, crimes against children, and sex related crimes. However, falsely swearing that you have not been convicted of a crime obligates the District to terminate employment or contract status even if the crime is not listed in ORS 342.143.
- D. No Employee shall have direct contact with students.
- E. All employees working on site for more than one day shall wear a Name and Photo Identification Badge. Any employee on site for less than one day shall wear a visitor badge. Badges shall be the responsibility of the Contractor to provide. Badge shall state the Willamette Education Service District, name of the project, employee name, and company they represent.

1.22 TOBACCO FREE EDUCATION FACILITY

- A. All bidders shall comply with OAR 581.021.0110 and ORS 326.051 regarding Tobacco Use on Public Grounds.
- B. For the purpose of this document "tobacco" is defined to include any lighted or unlighted cigarette, cigar, pipe, clove cigarette, and any other smoking product, spit tobacco, also known as smokeless, dip, chew, snuff, in any form, nicotine or nicotine delivering devices, chemicals or devices that produce the physical effect of nicotine substances or any other tobacco substitute (e.g., e-cigarettes). This does not include FDA approved nicotine replacement therapy products used for the purpose of cessation.



WILLAMETTE EDUCATION SERVICE DISTRICT
YAMHILL CENTER
SIDEWALK IMPROVEMENT PROJECT
INSTRUCTIONS TO BIDDERS
SECTION 00 2113

- C. No employee, sub-contractor, material supplier, or project visitor is permitted to smoke, inhale, dip, or chew or sell tobacco at any time, including non-education hours.
1. In any building, facility; or
 2. On education facility grounds, athletic grounds, or parking lots.

END OF SECTION