



This addendum forms a part of the Contract Documents and modifies the original Documents dated **September 26, 2022**, as noted below. Acknowledge receipt of this addendum in the space provided on the Official Bid Form. Failure to do so may subject the Bidder to disqualification.

### **QUESTIONS AND CLARIFICATIONS**

**Question:** To reduce lead times for the hollow metal frames, are bidders authorized to substitute the frame profile depicted in the plans for a standard profile frame with nailing flange?

**Answer:** Due to the thickness of the exterior skin assembly, the profile shown in the drawings must be retained. The anticipated construction period should allow time to source the non-standard frames.

**Question:** Are there additional specifications for electrical fixtures?

**Answer:** Code minimum is suitable; however, all lighting fixtures must be LED. Use Lithonia Lighting UFIT LED Low Bay series as basis of design for Apparatus Bay lights.

**Question:** Is the polystyrene core specified required on the exterior hollow metal doors or can honeycomb cores be substituted?

**Answer:** It does not appear honeycomb-core doors will achieve the R-value necessary to meet code requirements. Exterior hollow metal doors are required to have an R-value of 6 to meet energy code requirements for the building. Polystyrene cores meet this requirement.

**Question:** The room finish schedule lists several walls and ceilings in many rooms as "EXIST". Do these walls need to be painted?

**Answer:** No, areas labeled as existing will not be painted, except at areas that are patched/repaired as part of remodel work.

**Question:** Is painted OTS to limited to the exercise area only?

**Answer:** Yes, painted OTS is limited to the Exercise Room.

**Question:** Is the plywood wainscot throughout the apparatus bay intended to be painted?

**Answer:** Yes, paint plywood wainscot throughout the apparatus bay basic white to match walls.

**Question:** Is caulking of the batten strips on the exterior siding required?

**Answer:** No, caulking is not required.



**Question:** Are all three apparatus bay doors pre-finished?

**Answer:** Yes, apparatus bay doors shall be factory finished.

**Question:** Are Doors 105A, 105B and 112 Wood? The type of door is not denoted in the schedule.

**Answer:** Yes, Doors 105A, 105B and 112 are Wood.

**Question:** Door 105A is a pocket door, is a substitution to a swing opening like 105B authorized?

**Answer:** Please bid the pocket door 105A. There may be clearance issues preventing a swinging door.

**Question:** Does the building have or require a fire suppression sprinkler?

**Answer:** No, the building is non-sprinklered and is not required for this project.

**Question:** Are there specifications for the future generator and its location?

**Answer:** See attached revised plan sheets A1-01 and A2-01 for updated specifications for the generator conduit installation. This is conduit installation only.

#### **REVISION TO DRAWINGS**

A1-01

1. See clouded section

A2-01

1. See clouded section

**END OF ADDENDUM 2**

consultant

## Revisions

o. Description	Date
Addendum #2	10/13/22

stamp

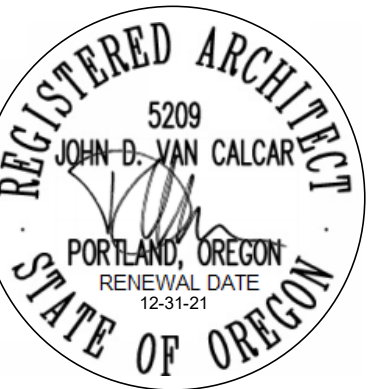

suance

**PERMIT / BID SET**

ate

09.09.22

Project Number

21058

Drawing Title

## ARCHITECTURAL SITE PLAN

Sheet No

# A1.01

1. ARCHITECTURAL SITE PLAN SHOWN FOR REFERENCE ONLY.
2. NO MODIFICATIONS PROPOSED TO SITE UNDER THIS PERMIT

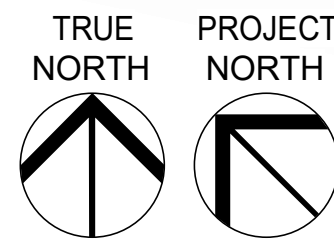

# 1 OVERALL SITE PLAN



SHEET NOTES

- 1. ANY EXTERIOR WALL NOT LABELED WITH A WALL TAG SHALL BE WALL TYPE: W01
- 2. ANY INTERIOR WALL NOT LABELED WITH A WALL TAG SHALL BE WALL TYPE: B01, WITH GYP TERMINATING AT UNDERSIDE OF ROOF DECK
- 3. REFER TO SHEET A0.11 FOR INTERIOR PARTITION TYPES AND KEY.
- 4. REFER TO DIMENSIONAL STANDARDS ON A0.11.

LEGEND

- SIM  
1=SECTION NO.  
A101= SHEET NO.
- PARTITION MARK  
(REF. INTERIOR ASSEMBLIES)
- DOOR TAG
- NEW WALL
- EXISTING WALL TO REMAIN
- EXISTING BEARING WALL TO REMAIN
- NEW BEARING WALL

LEGEND - KEYNOTES

MARK	DESCRIPTION
2001	EXISTING WALL TO REMAIN
2002	EXISTING DOOR TO REMAIN
2003	PROVIDE 4" DIA CONDUIT FOR FUTURE GENERATOR CONNECTION. PROVIDE PULL ROPE AND CAP AT BOTH ENDS. STUB TO EXTENTS INDICATED ON SITE PLAN.
2004	PROVIDE UNDERSLAB WASTE PIPING FOR RESTROOM AND LAUNDRY. SIZE FOR ONE ADDITIONAL TOILET, SHOWER, AND LAVATORY ABOVE WHAT IS SHOWN.
2005	NEW EXTERIOR WALL ASSEMBLY. SEE DETAIL 1/A0.11
2006	NEW COLUMN. SEE STRUCTURAL
2007	NEW BEARING WALL. SEE STRUCTURAL
2008	NEW SHEAR WALL. SEE STRUCTURAL
2009	REPLACE ANY FLOORING MATERIALS REMOVED OR DAMAGED DURING CONSTRUCTION WITH SAME TYPE.
2010	REPLACE EXISTING COUNTERTOPS, CABINETS, AND APPLIANCES REMOVED DURING CONSTRUCTION. CONNECT ALL PLUMBING AND ELECTRICAL HOOK-UPS.
2011	REPLACE ELECTRICAL SERVICE GEAR. MOUNT ON FIRE-TREATED PLYWOOD BACKING
2012	RE-INSTALL ANY LIGHTS OR HEATERS REMOVED DURING CONSTRUCTION. REPLACE ANY THAT WERE NOT SALVAGED.
2013	INSTALL RELOCATED GAS UNIT HEATER IN APP BAY. CONNECT ALL PIPING / VENTS
2014	REINSTALL / HOOK-UP WASHER/DRYER
2015	EXISTING MEZZANINE - SEE STRUCTURAL FOR ADDITIONAL INFORMATION
2016	NEW MEZZANINE ADDITION PER ALT NO. 3 - SEE STRUCTURAL FOR ADDITIONAL INFORMATION
2017	NEW 42" WALL. SEE 1/A0.11



Project

Consultant

Revisions

No.	Description	Date
2	Addendum #2	10/13/22

Stamp



Issuance

PERMIT / BID SET

Date

09.09.22

Project Number

21058

Drawing Title

FLOOR PLANS

Sheet No

A2.01

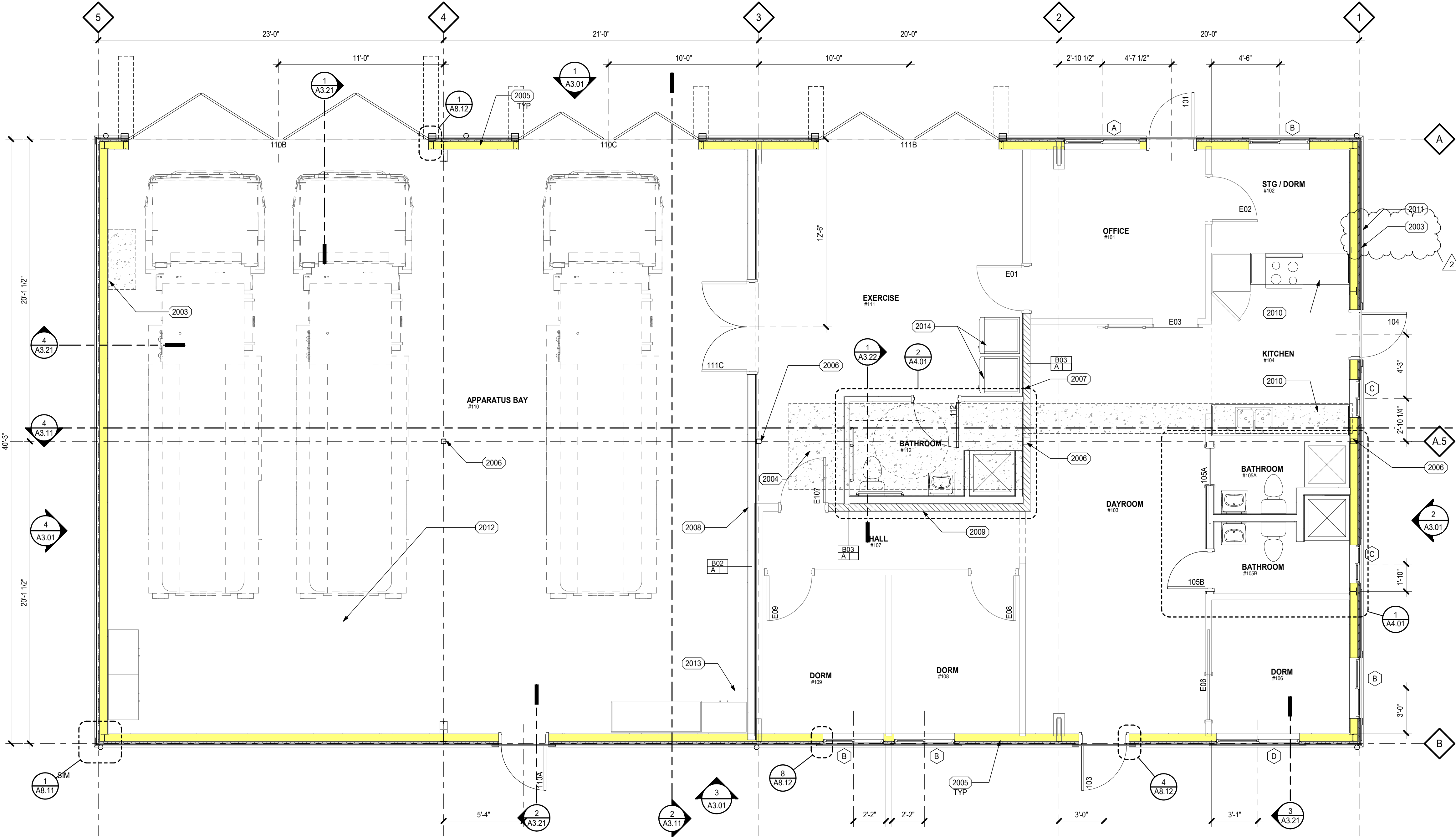

NORTH  
1 FIRST FLOOR PLAN  
1/4" = 1'-0"

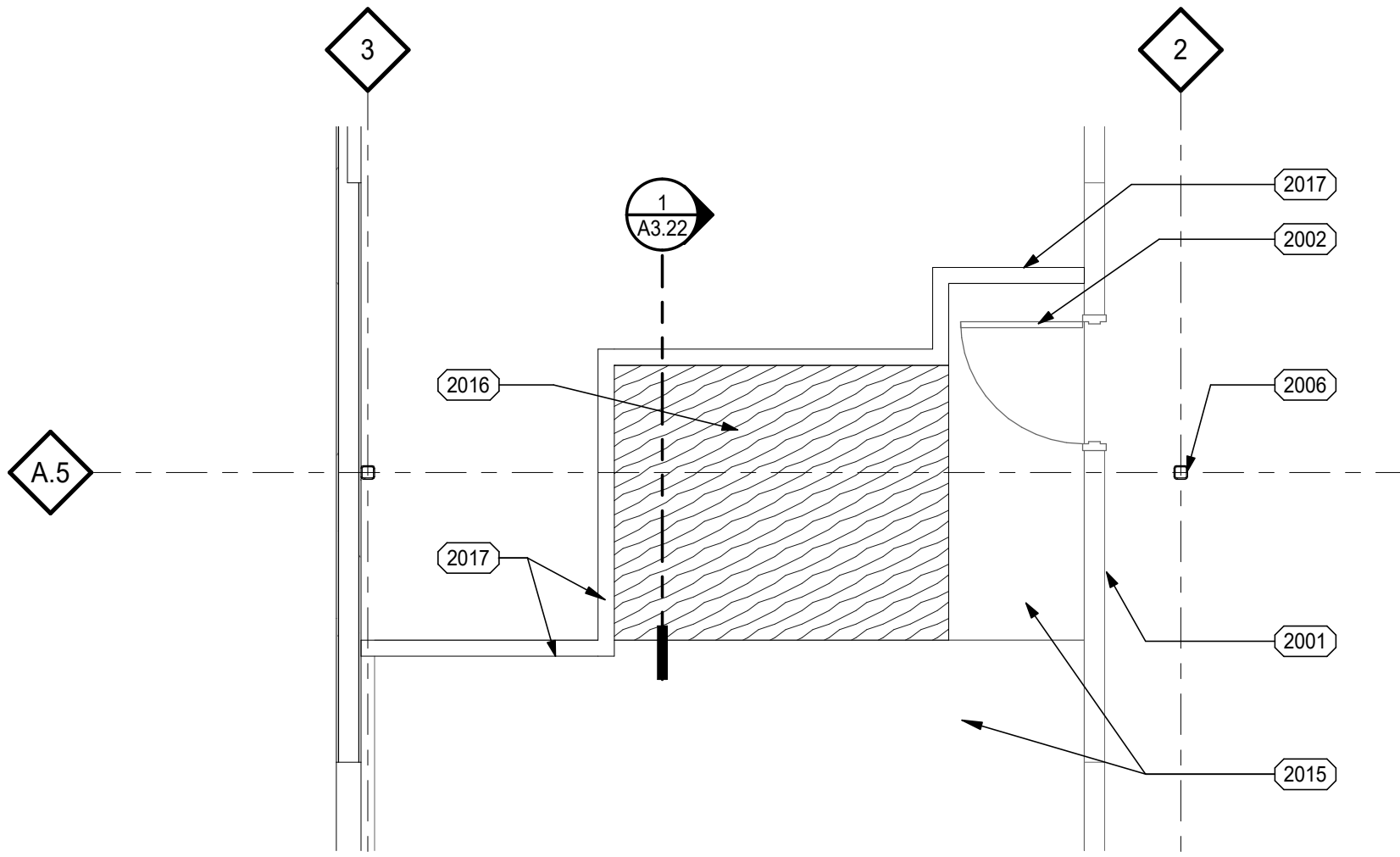

2 MEZZANINE PLAN  
1/4" = 1'-0"